

COUNCIL AGENDA: FEBRUARY 5, 2013

SUBJECT: INTENT TO SET A PUBLIC HEARING TO CONSIDER THE FORMATION OF SEWER UTILITY DISTRICT AREA 458

SOURCE: Public Works Department - Engineering Division

COMMENT: Staff respectfully requests that the City Council set a public hearing for April 2, 2013. The Public Hearing is to allow for "protest hearing" from property owners who live or own property within Sewer Utility District Area 458. Proposition 218 guidelines require forty-five days marked notice of the Public Hearing. A ballot must be included in the notice for property owners to vote for or against formation of the sewer utility district.

A Resolution declaring the Council's intent to create a sewer utility district is attached for Council's action. Proposition 218 Guidelines specify that the Public Works Director must prepare and present an Engineer's Report to the City Council prior to the public hearing. The Engineer's Report must provide:

- 1 A description of the improvements,
- 2 A cost estimate of the improvements,
- 3 Maps and/or drawings describing the boundaries of the utility district,
- 4 Methodology used by the Engineer of Record to equitably spread the cost of the improvements throughout the utility district, and
- 5 An assessment roll listing all parcels in the district and the proposed assessment against each parcel in the district.

RECOMMENDATION: That the City Council:

1. Set a Public Hearing for April 2, 2013, pursuant to Proposition 218 Guidelines, for consideration to form Sewer Utility District 458;
2. Approve the Engineer's Report for Sewer Utility District Area 458; and
3. Authorize staff to notify all affected property owners of the Public Hearing, via certified mail, including the sewer connection assessment amount, length of time provided on the assessment, reason for the assessment and a summary on how the voting will function.

ATTACHMENTS: Locator Map
Draft Resolution
Engineer's Report w/ Attachments
Draft Resolution

P:\pubworks\General\Council\Intent to Set Public Hearing for Formation of Sewer Utility District Area 458.doc

Disappropriated/Funded *MS* CM *ON* ACTING

Item No. 12

A RESOLUTION OF THE CITY COUNCIL OF THE
CITY OF PORTERVILLE APPROVING
INTENT TO FORM AN
ISLAND ANNEXATION AREA 458 SEWER UTILITY DISTRICT,
LEVYING THE ASSESSMENT, AND AUTHORIZING
THE CONSTRUCTION OF THE IMPROVEMENTS

WHEREAS, Island Annexation Area 458, was annexed into the City in November 2006; and

WHEREAS, the parcels in this area utilize individual septic tanks that are failing;
and

WHEREAS, the City Council of the City of Porterville unanimously approved the design of the Island Annexation 458A & 458B Project contingent upon the establishment of the Island Annexation Area 458 Sewer Utility District; and

WHEREAS, in accordance with California Streets and Highways Code Section 10000 et seq. and other applicable law, the property owners were provided with Notice of the public hearing and assessment ballot proceeding; and

WHEREAS, it is the intent of the City Council to hold a public hearing to receive comment from the public, accept and tabulate ballots; and

WHEREAS, the property owners within the proposed District will be given the opportunity to cast ballots at the end of the public hearing to be held on April 2, 2013, and approve the imposition of the assessment and the formation of the District;

NOW THEREFORE BE IT RESOLVED, that it is the intention of the City Council of the City of Porterville to:

- 1) Approve the formation of the Island Annexation Area 458 Sewer Utility District establishing an assessment to pay for the installation of new sewer mains and laterals. A diagram of the District setting forth the boundaries and parcels located within the District is attached hereto as Exhibit "B;"
- 2) Authorize the levying of the assessment as set forth in Exhibit "C;"
- 3) Authorize the City to permit property owners to pay the total one-time assessment on a bi-yearly basis through property taxes over a period of 30 years, with 3% interest. This cost shall be as set forth in Exhibit "C."

PASSED, APPROVED AND ADOPTED this 5th day of February, 2013.

Virginia R. Gurrola, Mayor

ATTEST:
John D. Lollis, City Clerk

By: _____
Patrice Hildreth, Chief Deputy City Clerk

CITY OF PORTERVILLE
ENGINEER'S REPORT FOR ISLAND ANNEXATION AREA 458
SEWER PROJECT

SECTION 1. Authority for Report

This report is prepared by order of the City Council of the City of Porterville Resolution

No. _____ . **This assessment is authorized pursuant to the Municipal**

Improvement Act of 1913 (California Streets and Highways Code Section 10000 et seq.)

and California Constitution Article XIID, Section 4. The report is in compliance with the requirements **of California Streets and Highways Code Section 10204.**

SECTION 2. General Description

The City Council has elected to finance the Island Annexation Area 458 Sewer Facility District (hereinafter referred to as "District") which includes the installation of approximately 170' of 8" sewer main, 16,540' of 6" sewer mains, 412 sewer laterals and 43 manholes.

The City Council has determined that the new sewer system will have a positive effect upon all parcels within the proposed boundaries of the "District". Proposed sewer laterals will be provided on both sides of the streets to all parcels located within the district. The installed sewer system will be maintained and operated by the City of Porterville.

SECTION 3. Plans and Specifications

The plans and specifications for the "District" were prepared by the City of Porterville's Public Works Department, Engineering Division and are in conformance with City Standards and Specifications. The sewer mains, laterals and manholes are shown on the plans approved by the City Council on November 06, 2012. The total length of 8" & 6" sewer mains to be maintained is 16,710 L.F. **The plans and specifications for the project are on file with the Public Works Department of the City and are hereby incorporated by reference.**

SECTION 4. Improvements

Improvements to be constructed include:

170 LF of 8" sewer main, 16,540 LF of 6" sewer main, 412 sewer laterals and 43 manholes and other sewer related appurtenances.

SECTION 5. Estimated Costs

The initial construction cost will be borne by the City through a loan from re-financed Certificate of Participation Bond Sewer funds. Payment on the loan will be made by a "one-time" assessment on the properties within the district receiving sewer facilities and paid annually over thirty (30) years by agreement between the City of Porterville and the Property Owner. A "District" map will be filed for record purposes upon voter approval of the "District" and installation of the improvements. The assessments are appropriate and will be used to pay the loan for construction and construction management of the Island Annexation Area 458 Sewer Project. District assessments will begin in the 2013-2014 Fiscal Year and will end in the 2043/2044 Fiscal Year. Assessments are based on the cost of construction and includes all or a portion of a 10% Construction Contingency and a Construction Management fee component. The "Actual Cost of Construction" is shown in Exhibit "C" attached herein.

SECTION 6. Assessment Legal Description & Boundary Map

A legal description and copy of the proposed assessment Boundary Map titled "Island Annexation Area 458 Sewer Facility District", referenced as Exhibit "A" and Exhibit "B" respectively is attached herein for review.

SECTION 7. Assessment

The initial cost of constructing improvements will be borne by the City of Porterville. The improvements are established for the benefit of all properties within the proposed Island Annexation Area 458 Sewer Facility District. The maintenance of the improvements (sewer mains and manholes) shall be performed by the City in perpetuity. The City Council of Porterville has determined that in order to pay for the construction of the 8" and 6" sewer main and related appurtenances, those properties in Exhibit 'A', should form a sewer facility district and that said district pay a semi-annual fee incorporated into the County's tax roll to cover the cost of construction and construction management of the Island Annexation Area 458 Sewer Project.

The determination of benefits takes into consideration the following facts:

1. The purpose of the improvements is to provide a reliable, consistent and safe method of sewer disposal.
2. A safe and reliable sewer system benefits all properties within the "District".
3. The parcels (lots) not adjacent to the newly installed 8" and 6" sewer mains shall have the opportunity to connect to a sewer lateral located at or near the Public Right of Way and extend private sewer laterals to those parcels (lots) in question.

Exhibit "C", attached herein provides the following information:

Column 1 - Identifies the Property Number of the parcel located within the "District".

Column 2 – Identifies the street address of the parcel within the "District".

Column 3 - Identifies the Property Owner of the parcel within the "District" based on latest Tulare County Tax Roll.

Column 4 – Identifies the parcel within the “District” by County Assessor Number.

Column 5 – Identifies the parcel within the “District” by square footage.

Column 6 – Identifies the parcel within the “District” based on acreage.

Column 7 – Identifies the acreage fee per acre for each lot within the “District” based on actual construction cost. This cost includes a 10% “Construction Contingency”

Column 8 – Identifies the Zoning for each parcel within the “District”.

Column 9 – Identifies the width of each parcel within the “District”

Column 10 – Identifies the number of residential units per lot.

Column 11 – Identifies “Acreage” fee per lot based on the construction cost (Col. 6 x Col. 7) with the 10% construction contingency included.

Column 12 – Identifies Sewer Lateral cost per lot within the “District” based on actual construction cost plus a 10% construction contingency.

Column 13 – Identifies Plumbing Permit fee per lot within the “District”. This fee will not be assessed and must be paid by the property owner prior to connecting to the City sewer system.

Column 14 – Identifies Construction Management cost per lot within the “District” based on 5% of the construction cost.

Column 15 – Identifies the Total Connection Fee per lot within the “District”

NOTE: Column 15 identifies the actual assessment per parcel (lot) based on construction and construction management costs and is the sum of Columns 11, 12 & 14. This fee (cost) is the amount to be assessed each parcel over the life of the Island Annexation Area 458 Sewer Facility District loan.

The "Assessed Cost" per "typical" parcel is calculated as follows:

Column 11 = Construction bid + 10% contingency / Total Acreage within "District" x

Individual Parcel Size = $(\$1,384,466.24 + \$138,446.62) / 113.2606 \text{ Ac.} \times 0.28 \text{ Ac.} = \mathbf{\$3,764.91}$

Column 12 = Cost of sewer lateral per parcel = $\$921.60 + 92.16 = \mathbf{\$1,013.76}$

Column 14 = Construction Management Cost = $(\$1,831,759.04 \times 5\%) / 449 \text{ Serviceable Lots} =$
\\$203.98 per lot. Use \\$200/lot

Column 15 = Total Assessment per Parcel (Lot) = Col 11 + Col. 12 + Col. 14 = **\\$4,978.67**

Semi-Annual Payment Calculated As Follows:

$$A = P(i/12) [(1+i/12)^n / (1+i/12)^n - 1]$$

Where:

A = Semi-Annual Assessment (payment) per Residential Unit

P = Per Residential Unit Cost for Construction, Construction Management & Sewer Lateral Cost
= **\\$4,978.67**

i = Interest (3%) compounded semi-annually = $.03/2 = .015$

n = Number of payments over 30 years = 60

Per Residential Unit Assessment Calculated as follows:

$$A = \$4,978.67 \times .015 \times [(1.015)^{60} / (1.0025)^{60} - 1] = \mathbf{\$126.43}$$

Baldomero Rodriguez, P.E.
Public Works Director
City of Porterville
Engineer of Record

EXHIBIT "A"
City of Porterville
Annexation No. 458, Area A
Description for Annexation

That portion of Section 27, Township 21 South, Range 27 East, Mount Diablo Base and Meridian, in the County of Tulare, State of California, described as follows:

Commencing at the Southwest corner of said Section 27, Township 21 South, Range 27 East; thence, easterly along the South line of the Southwest quarter of Section 27, a distance of 40 feet, more or less, to the intersection with the southerly prolongation of the East right of way line of Newcomb Street; thence, northerly, along said southerly prolongation of the East right of way line of Newcomb Street and said East right of way line, a distance of 330 feet, more or less, to an angle point on the existing City Limits Line, the TRUE POINT OF BEGINNING;

A1 Thence, continuing northerly, along the existing City Limits Line and the East right of way line of Newcomb Street, a distance of 299 feet, more or less, to the South right of way line of Tomah Avenue, an angle point in the existing City Limits Line;

A2 Thence, easterly, along the existing City Limits Line and South right of way line of Tomah Avenue, a distance of 354.67 feet, more or less, to an angle point in the existing City Limits Line;

A3 Thence, northerly, along the existing City Limits Line, a distance of 540.90 feet, more or less, to an angle point in the existing City Limits Line;

A4 Thence, westerly, along the existing City Limits Line, a distance of 82 feet, more or less, to an angle point in the existing City Limits Line;

A5 Thence, northerly, along the existing City Limits Line, a distance of 174 feet, more or less, to the North right of way line of Putnam Avenue, an angle point in the existing City Limits Line;

A6 Thence, westerly, along the existing City Limits Line and the North right of way line of Putnam Avenue, a distance of 273 feet, more or less, to the East right of way line of Newcomb Street, an angle point in the existing City Limits Line;

A7 Thence, northerly, along the existing City Limits Line and the East right of way line of Newcomb Street, a distance of 1328 feet, more or less, to the North right of way line of Morton Avenue, an angle point in the existing City Limits Line;

A8 Thence, easterly, along the existing City Limits Line and North right of way line of Morton Avenue, a distance of 1292 feet, more or less, to the intersection with the

northerly prolongation of the East line of Tract 264 as recorded in Volume 22 of Maps, Page 14, Tulare County Records, an angle point in the existing City Limits Line;

A9 Thence, southerly, along the existing City Limits Line and the northerly prolongation of the East line of said Tract 264 and the East line of said Tract 264, a distance of 1394.31, more or less, to the South right of way line of Putnam Avenue, an angle point in the existing City Limits Line;

A10 Thence, easterly, along the existing City Limits Line and the South right of way line of Putnam Avenue, a distance of 199.27 feet, more or less, to an angle point in the existing City Limits Line;

A11 Thence, southerly, along the existing City Limits Line, a distance of 308 feet, more or less, to an angle point in the existing City Limits Line;

A12 Thence, westerly, along the existing City Limits Line, a distance of 66.52 feet, more or less, to an angle point in the existing City Limits Line;

A13 Thence, southerly, along the existing City Limits Line, a distance of 303.44 feet, more or less, to the North right of way line of Tomah Avenue, an angle point in the existing City Limits Line;

A14 Thence, westerly, along the existing City Limits Line and the North right of way line of Tomah Avenue, a distance of 132.85 feet, more or less, to the intersection with the southerly prolongation of the East line of said Tract 264, an angle point in the existing City Limits Line;

A15 Thence, southerly, along the existing City Limits and the southerly prolongation of the East line of said Tract 264, a distance of 50 feet, more or less, to the South right of way line of Tomah Avenue, an angle point in the existing City Limits Line;

A16 Thence, westerly, along the existing City Limits Line and the South right of way line of Tomah Avenue, a distance of 331 feet, more or less, to the intersection with the East line of West half of the East half of the Southwest quarter of said Section 27, an angle point in the existing City Limits Line;

A17 Thence, southerly, along the existing City Limits Line and the East line of West half of the East half of the Southwest quarter of said Section 27, a distance of 254 feet, more or less, to an angle point in the existing City Limits Line;

A18 Thence, westerly, along the existing City Limits Line, a distance of 100 feet, more or less, to an angle point in the existing City Limits Line;

A19 Thence, northerly, along the existing City Limits Line, a distance of 254.14 feet, more or less, to the South right of way line of Tomah Avenue, an angle point in the existing City Limits Line;

A20 Thence, westerly, along the existing City Limits Line and the South right of way line of Tomah Avenue, a distance of 129.22 feet, more or less, an angle point in the existing City Limits Line;

A21 Thence, southerly, along the existing City Limits Line, a distance of 254.16 feet, more or less, to an angle point in the existing City Limits Line;

A22 Thence, westerly, along the existing City Limits Line, a distance of 100 feet, more or less, to the intersection with the East line of the Southwest quarter of the Southwest quarter of the Southwest quarter of said Section 27, an angle point in the existing City Limits Line;

A23 Thence, southerly, along the existing City Limits Line and the East line of the Southwest quarter of the Southwest quarter of the Southwest quarter of said Section 27, a distance of 50 feet, more or less, to an angle point in the existing City Limits Line;

A24 Thence, westerly, along the existing City Limits Line, a distance of 200 feet, more or less, to an angle point in the existing City Limits Line, the TRUE POINT OF BEGINNING.

ACREAGE = 63 ± ACRES

EXHIBIT "A"
City of Porterville
Annexation No. 458, Area B
Description for Annexation

That portion of Section 28 and 27, Township 21 South, Range 27 East, Mount Diablo Base and Meridian, in the County of Tulare, State of California, described as follows:

Commencing at the Southeast corner of said Section 28, Township 21 South, Range 27 East; thence, westerly along the South line of the Southeast quarter of Section 28, a distance of 40 feet, more or less, to the intersection with the southerly prolongation of the West right of way line of Newcomb Street; thence, northerly, along said southerly prolongation of the West right of way line of Newcomb Street and said West right of way line, a distance of 276 feet, more or less, to an angle point on the existing City Limits Line, the Southeast corner of Lot 5 of Tract No. 257 as recorded in Volume 22 of Maps, Page 10, Tulare County Records, the TRUE POINT OF BEGINNING;

B1 Thence, westerly, along the existing City Limits Line and the South line of Lots 5, 9, 10, and 11 of said Tract No. 257, a distance of 388.01 feet, more or less, to an angle point in the existing City Limits Line;

B2 Thence, northwesterly, along the existing City Limits Line and the South line of Lots 11 and 12 of said Tract No. 257, a distance of 49.00 feet, more or less, to an angle point in the existing City Limits Line;

B3 Thence, southwesterly, along the existing City Limits Line, a distance of 20.00 feet, more or less, to an angle point in the existing City Limits Line;

B4 Thence, northwesterly, along the existing City Limits, a distance of 30.00 feet, more or less, to an angle point in the existing City Limits Line;

B5 Thence, southwesterly, along the existing City Limits Line, a distance of 29.75 feet, more or less, to an angle point in the existing City Limits Line;

B6 Thence, northwesterly, along the existing City Limits Line, a distance of 225 feet, more or less, to an angle point in the existing City Limits Line;

B7 Thence, continuing northwesterly, along the existing City Limits Line, a distance of 153.60 feet, more or less, to an angle point in the existing City Limits Line;

B8 Thence, continuing northwesterly, along the existing City Limits Line, a distance of 85.78 feet, more or less, to an angle point in the existing City Limits Line;

B9 Thence, continuing northwesterly, along the existing City Limits Line, a distance of 106.32 feet, more or less, to an angle point in the existing City Limits Line;

B10 Thence, southerly, along the existing City Limits Line, a distance of 93.27 feet, more or less, to an angle point in the existing City Limits Line;

B11 Thence, northwesterly, along the existing City Limits Line, a distance of 178.69 feet, more or less, to an angle point in the existing City Limits Line;

B12 Thence, continuing northwesterly, along the existing City Limits Line, a distance of 337.32 feet, more or less, to an angle point in the existing City Limits Line;

B13 Thence, westerly, along the existing City Limits Line, a distance of 72.00 feet, more or less, to an angle point in the existing City Limits Line;

B14 Thence, northerly, along the existing City Limits Line, a distance of 190.00 feet, more or less, to an angle point in the existing City Limits Line;

B15 Thence, westerly, along the existing City Limits Line, a distance of 897.67 feet, more or less, to an angle point in the existing City Limits Line;

B16 Thence, northerly, along the existing City Limits Line, a distance of 395.00 feet, more or less, to an angle point in the existing City Limits Line;

B17 Thence, easterly, along the existing City Limits Line, a distance of 917.03 feet, more or less, to an angle point in the existing City Limits Line;

B18 Thence, northerly, along the existing City Limits Line, a distance of 114 feet, more or less, to the South right of way line of Putnam Avenue, an angle point in the existing City Limits Line;

B19 Thence, easterly, along the existing City Limits Line and the South right of way line of Putnam Avenue, a distance of 80.06 feet, more or less, to the intersection with the southerly prolongation of the West line of Tract No. 14 per map recorded in Volume 19 of maps, at Page 50, Tulare County Records, an angle point in the existing City Limits Line;

B20 Thence, northerly, along the existing City Limits Line, the southerly prolongation of the West line of said Tract No. 14, and said West line, a distance of 1328.80 feet, more or less, to the South right of way line of Morton Avenue, an angle point in the existing City Limits Line;

B21 Thence, easterly, along the existing City Limits Line and the South right of way line of Morton Avenue, a distance of 496.45 feet, more or less, to an angle point in the existing City Limits Line;

B22 Thence, southerly, along the existing City Limits Line and the South right of way line of Morton Avenue, a distance of 5.0 feet, more or less, to an angle point in the existing City Limits Line;

B23 Thence, easterly, along the existing City Limits Line and the South right of way line of Morton Avenue, a distance of 111.58 feet, more or less, to the intersection with the southerly prolongation of the West line of Tract No. 270 as per map recorded in Volume 22 of maps, Page 16, Tulare County Records, an angle point in the existing City Limits Line;

B24 Thence, northerly, along the existing City Limits Line, the southerly prolongation of the West line of said Tract No. 270, and said West line, a distance of 339.5 feet, more or less, to the South right of way line of Morton Avenue, an angle point in the existing City Limits Line;

B25 Thence, easterly, along the existing City Limits Line and the West line of said Tract No. 270, a distance of 16.5 feet, more or less, to an angle point in the existing City Limits Line;

B26 Thence, northerly, along the existing City Limits Line and the West line of said Tract No. 270, a distance of 49.5 feet, more or less, to an angle point in the existing City Limits Line;

B27 Thence, westerly, along the existing City Limits Line and the West line of said Tract No. 270, a distance of 16.5 feet, more or less, to an angle point in the existing City Limits Line;

B28 Thence, northerly, along the existing City Limits Line and the West line of said Tract No. 270, a distance of 560.7 feet, more or less, to the South line of the North half of the North half of the South East quarter of the Northeast quarter of Section 28, an angle point in the existing City Limits Line;

B29 Thence, easterly, along the existing City Limits Line and said South line, a distance of 461 feet, more or less, to the East line of said Tract No. 270, an angle point in the existing City Limits Line;

B30 Thence, southerly, along the existing City Limits Line and the East line of said Tract No. 270, a distance of 25.95 feet, more or less, to the approximate centerline of Porter Slough, an angle point in the existing City Limits Line;

B31 Thence, southeasterly, along the existing City Limits Line and the approximate centerline of Porter Slough, a distance of 179.38 feet, more or less, to an angle point in the existing City Limits Line;

B32 Thence, continuing southeasterly, along the existing City Limits Line and the approximate centerline of Porter Slough, a distance of 330.92 feet, more or less, to the East line of the Northeast quarter of said Section 28, an angle point in the existing City Limits Line;

B33 Thence, easterly, along the existing City Limits Line, a distance of 40 feet, more or less, to the East right of way line of Newcomb Street (Road 232), an angle point in the existing City Limits Line;

B34 Thence, southerly, along the existing City Limits Line and East right of way line of Newcomb Street (Road 232), a distance of 653 feet, more or less, to a point being 10 feet North of the North right of way line of Morton Avenue, an angle point in the existing City Limits Line;

B35 Thence, westerly, along the existing City Limits Line, a distance of 80 feet, more or less, to the West right of way line of Newcomb Street (Road 232), an angle point in the existing City Limits Line;

B36 Thence, southerly, along the existing City Limits Line and the West right of way line of Newcomb Street (Road 232), a distance of 1351 feet, more or less, to the North right of way line of Putnam Street, an angle point in the existing City Limits Line;

B37 Thence, westerly, along the existing City Limits Line and the North right of way line of Putnam Street, a distance of 966 feet, more or less, an angle point in the existing City Limits Line;

B38 Thence, southerly, along the existing City Limits, a distance of 727 feet, more or less, to the South right of way line of Tomah Avenue, an angle point in the existing City Limits Line;

B39 Thence, easterly, along the existing City Limits Line and the South right of way line of Tomah Avenue, a distance of 939 feet, more or less, to the point of curvature of a 20 foot radius curve concave northeasterly, an angle point in the existing City Limits Line;

B40 Thence, southeasterly, along the existing City Limits Line and along said curve, a distance of 31 feet, more or less, to the point of tangency of said curve and the West right of way line of Newcomb Street (Road 232), an angle point in the existing City Limits Line;

B41 Thence, southerly, along the existing City Limits Line and the West right of way line of Newcomb Street (Road 232), a distance of 352 feet, more or less, to the South right of way line of Putnam Street, to an angle point on the existing City Limits Line, the Southeast corner of Lot 5 of said Tract No. 257, the TRUE POINT OF BEGINNING;

ACREAGE = 86 ± ACRES

DATE	BY	DESCRIPTION

REVISIONS

EXHIBIT B ANNEXATION No. 458

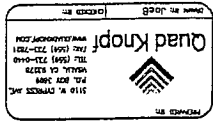

City of Porterville

DATE: July 27, 2005
 PLAN NO: 04617-05
 SHEET NO: 1 OF 1
 SCALE: 1"=100'

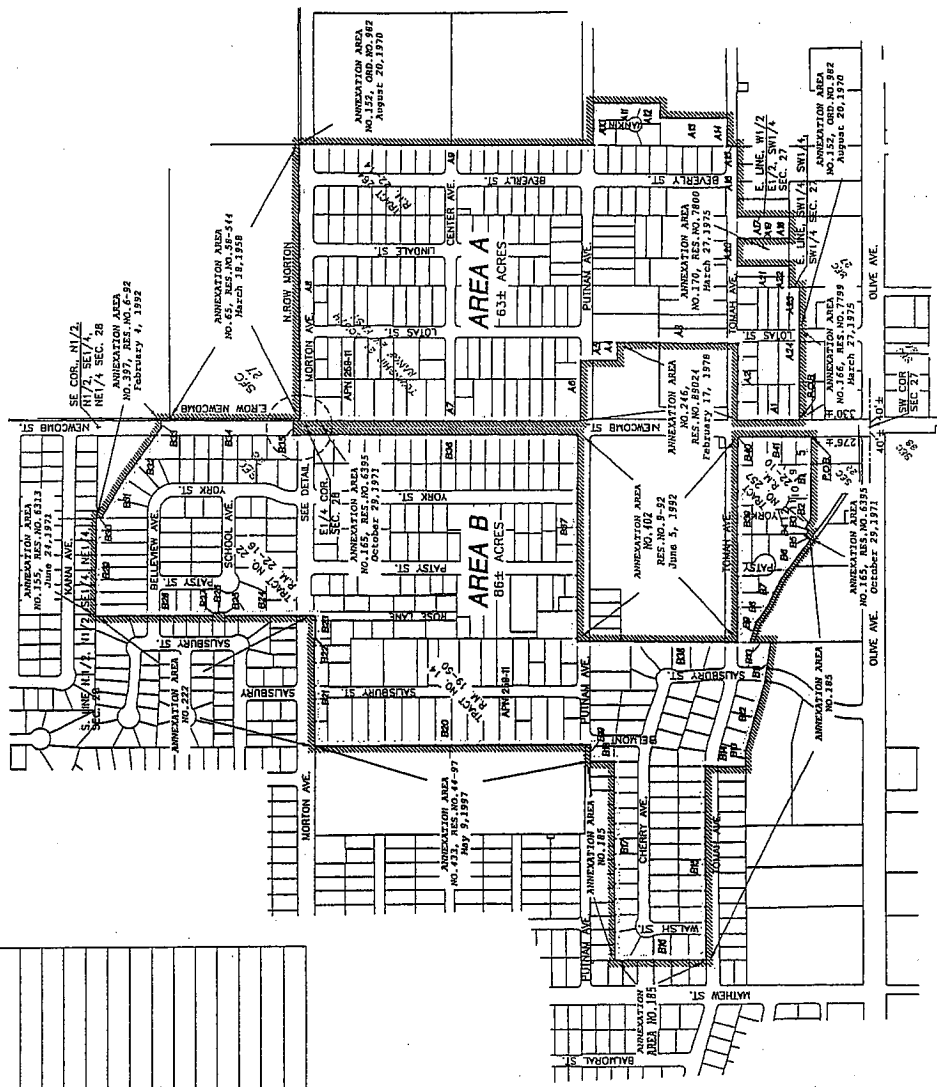
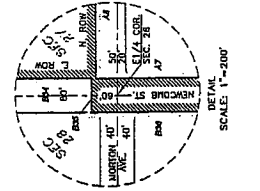
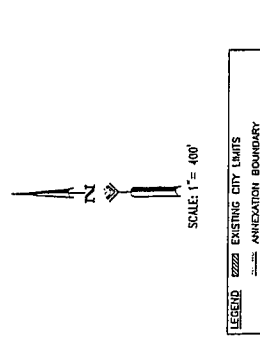

LINE	DIST.	APNS IN AREA - ALONG BOUNDARY
A1	299' +/-	251-291-020,018,016,014,022
A2	354.67' +/-	251-291-022,020,023,021,019,017,015,013,011,009,007,005,003,001,025
A3	540.90' +/-	251-301-030,002
A4	82' +/-	251-301-035
A5	174' +/-	251-301-035
A6	273' +/-	251-311-017,015,013,011,009,007,005,003,001,025
A7	1328' +/-	251-311-017,015,013,011,009,007,005,003,001,025
A8	1292' +/-	---
A9	1394.31' +/-	251-324-001,002,003,004,005,006,007,008,009,010,011,012,013,014,015,016,017,018,019,020,021,022,023,024,025
A10	199.27' +/-	251-271-003,022
A11	308' +/-	251-271-022,007
A12	66.92' +/-	251-271-007
A13	303.44' +/-	251-271-021
A14	132.85' +/-	251-271-021
A15	50' +/-	---
A16	331' +/-	---
A17	254' +/-	251-292-010
A18	100' +/-	251-292-010
A19	284.14' +/-	251-292-010
A20	129.22' +/-	---
A21	254.18' +/-	251-292-008
A22	100' +/-	251-292-008,007
A23	50' +/-	251-291-001
A24	200' +/-	251-291-001,008,020

LINE	DIST.	APNS IN AREA - ALONG BOUNDARY
B1	388.01' +/-	245-120-025,023,021,019,017,015,013,011,009,007,005,003,001,014
B2	49.00' +/-	245-120-014,012
B3	20.00' +/-	245-120-013
B4	30.00' +/-	245-120-013
B5	23.75' +/-	245-120-006
B6	225' +/-	245-120-006,005
B7	153.60' +/-	245-120-003,005
B8	85.78' +/-	245-120-002
B9	106.32' +/-	245-120-001
B10	93.27' +/-	245-163-005,003
B11	178.69' +/-	245-163-011
B12	337.32' +/-	245-164-005,004,003,002,001
B13	72.00' +/-	245-164-001
B14	190.00' +/-	245-164-001
B15	897.67' +/-	245-165-003,002,001,000,009,008,007,006,005,004,003,002,001,018
B16	395.00' +/-	245-161-016,017,018,019,020,021,022,023,024,025
B17	917.03' +/-	245-161-016,015,014
B18	114' +/-	245-161-001
B19	80.08' +/-	245-161-001
B20	1328.80' +/-	245-174-003,002,001,000,009,008,007,006,005,004,003,002,001,018
B21	696.45' +/-	245-174-003,002,001,000,009,008,007,006,005,004,003,002,001,018
B22	5.0' +/-	245-101-008
B23	111.90' +/-	245-101-009
B24	339.5' +/-	245-083-015,004,003
B25	16.5' +/-	245-093-003
B26	49.5' +/-	245-093-003,002
B27	16.5' +/-	245-083-002
B28	560.7' +/-	245-083-001; 245-083-002,001
B29	461' +/-	245-081-001,002,003,004,005,006,007,008
B30	25.95' +/-	245-081-008
B31	178.38' +/-	245-081-009,010
B32	330.97' +/-	245-081-001,012,014
B33	40' +/-	---
B34	653' +/-	251-010-001
B35	80' +/-	---
B36	1,351' +/-	245-087-008; 245-103-005,006,007,008,009,010,011,012,013
B37	966' +/-	245-115-009,008,007,006,005,004,003,002,001,018,019,020,021,022,023,024,025
B38	727' +/-	245-150-050,054
B39	939' +/-	245-120-001,002,003,004,005,006,007,008,009,010,011,012,013
B40	31' +/-	245-120-021
B41	352' +/-	245-120-021,022,023,024,025

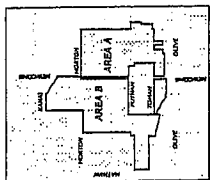

VICINITY MAP - NO SCALE

Annexation Area: 458

EXHIBIT "C"

(1)	(2)	(3)	(4)	(5)	(6)	(7)	(8)	(9)	(10)	(11)	(12)	(13)	(14)	(15)
Property No.	Property Address	Owner	Assessor Parcel No.	Lot Area (SF)	Lot Area (AC)	Acreage Fee/Acre	Zoning	Lot Front Footage	Units per Lot	Acreage Fee	Sewer Lateral Cost	Permitting	Construction Management Cost	Total Connection Fees
										(6) x (17)				(11) x (12) + (14)
97	1730 W BELLEVUE	HETHERINGTON THOMAS D & JEANINE M (245081001	13303.4431	0.3038	\$13,446.10	RS-2	57	1	\$4,198.36	\$1,013.76	\$800.00	\$200.00	\$5,298.66
98	1722 W BELLEVUE	LAWSON DANIEL & AMY	245081002	13204.2452	0.3123	\$13,446.10	RS-2	57	1	\$4,198.36	\$1,013.76	\$800.00	\$200.00	\$5,298.66
99	1714 BELLEVUE	PHILLIPS MARY JEAN	245081003	14204.0868	0.3261	\$13,446.10	RS-2	57	1	\$4,384.51	\$1,013.76	\$800.00	\$200.00	\$5,598.27
100	1710 BELLEVUE	FAIRCHILD CHARLEY JEAN	245081004	13706.2002	0.3147	\$13,446.10	RS-2	57	1	\$4,230.83	\$1,013.76	\$800.00	\$200.00	\$5,444.59
101	1698 W BELLEVUE	OSULLIVAN THOMAS J & DEBORAH L	245081005	13467.4847	0.3092	\$13,446.10	RS-2	57	1	\$4,157.14	\$1,013.76	\$800.00	\$200.00	\$5,370.90
102	1696 W BELLEVUE	COOK JOSEPH C & DOROTHY C	245081006	13717.0704	0.3149	\$13,446.10	RS-2	57	1	\$4,234.17	\$1,013.76	\$800.00	\$200.00	\$5,447.93
103	1678 W BELLEVUE	WARZEE LEONIA M	245081007	13738.6812	0.3152	\$13,446.10	RS-2	57	1	\$4,238.39	\$1,013.76	\$800.00	\$200.00	\$5,452.15
104	1670 W BELLEVUE	ALVAREZ ALVARO G & MARIA J	245081008	13966.8929	0.3206	\$13,446.10	RS-2	56	1	\$4,311.30	\$1,013.76	\$800.00	\$200.00	\$5,525.06
105	1652 W BELLEVUE	CHA JE	245081009	13894.6930	0.3190	\$13,446.10	RS-2	52	1	\$4,289.01	\$1,013.76	\$800.00	\$200.00	\$5,502.77
106	1650 W BELLEVUE	WARD BRIAN	245081010	12778.2036	0.2796	\$13,446.10	RS-2	51	1	\$4,198.36	\$1,013.76	\$800.00	\$200.00	\$5,072.24
107	462 N YORK	PHILLIPS HAREL W & GAIL A (TRS)	245081011	10758.6533	0.2470	\$13,446.10	RS-2	51	1	\$3,750.85	\$1,013.76	\$800.00	\$200.00	\$4,665.41
108	460 N YORK	WALKER BELTWAY	245081012	10758.6533	0.2470	\$13,446.10	RS-2	51	1	\$3,750.85	\$1,013.76	\$800.00	\$200.00	\$4,665.41
109	458 N YORK	WALKER BELTWAY	245081013	10758.6533	0.2470	\$13,446.10	RS-2	51	1	\$3,750.85	\$1,013.76	\$800.00	\$200.00	\$4,665.41
110	456 N YORK	WALKER BELTWAY	245081014	10758.6533	0.2470	\$13,446.10	RS-2	51	1	\$3,750.85	\$1,013.76	\$800.00	\$200.00	\$4,665.41
111	454 N YORK	BOHLE TARA DE	245081015	10758.6533	0.2470	\$13,446.10	RS-2	51	1	\$3,750.85	\$1,013.76	\$800.00	\$200.00	\$4,665.41
112	452 N YORK	GUERRERO JUAN E	245081016	10758.6533	0.2470	\$13,446.10	RS-2	51	1	\$3,750.85	\$1,013.76	\$800.00	\$200.00	\$4,665.41
113	450 N YORK	RAMIREZ ALFONSO J & JUDY C	245081017	10758.6533	0.2470	\$13,446.10	RS-2	51	1	\$3,750.85	\$1,013.76	\$800.00	\$200.00	\$4,665.41
114	448 N YORK	DIX ANTHONY	245081018	10758.6533	0.2470	\$13,446.10	RS-2	51	1	\$3,750.85	\$1,013.76	\$800.00	\$200.00	\$4,665.41
115	1691 W BELLEVUE	AGEE RAYMOND E	245082002	10354.0173	0.2327	\$13,446.10	RS-2	67	1	\$3,129.21	\$1,013.76	\$800.00	\$200.00	\$4,342.97
116	1681 W BELLEVUE	FORD DONALD G JR	245082003	10412.1244	0.2390	\$13,446.10	RS-2	67	1	\$3,246.74	\$1,013.76	\$800.00	\$200.00	\$4,427.50
117	1668 W BELLEVUE	MONJARAS FIDENCIO O	245082004	10441.1050	0.2409	\$13,446.10	RS-2	67	1	\$3,246.74	\$1,013.76	\$800.00	\$200.00	\$4,427.50
118	493 N PATSY	JOHNSON ALYWARD J & FRANCES H (TRS)	245082005	10842.1244	0.2489	\$13,446.10	RS-2	67	1	\$3,246.74	\$1,013.76	\$800.00	\$200.00	\$4,427.50
119	489 N PATSY	ATKINS DORETHA	245083001	9989.2632	0.2293	\$13,446.10	RS-2	60	1	\$2,661.18	\$1,013.76	\$800.00	\$200.00	\$4,292.25
120	470 N PATSY	RODRIGUEZ JOSE G & MARIA S	245083002	8718.3503	0.2001	\$13,446.10	RS-2	70	1	\$2,091.18	\$1,013.76	\$800.00	\$200.00	\$4,255.75
121	1690 W SCHOOL	JCH FAMILY LIMITED PTNSHP	245091001	9654.8459	0.2262	\$13,446.10	RS-2	130	1	\$3,041.99	\$1,013.76	\$800.00	\$200.00	\$4,255.75
122	1690 W SCHOOL	NIX WILLIAM G	245091002	10404.7806	0.2389	\$13,446.10	RS-2	67	1	\$3,211.76	\$1,013.76	\$800.00	\$200.00	\$4,425.51
123	1690 W SCHOOL	PAIGE JEANIE KAY	245091003	9665.5092	0.2265	\$13,446.10	RS-2	67	1	\$3,045.28	\$1,013.76	\$800.00	\$200.00	\$4,259.04
124	1672 W SCHOOL	DARE BETTY LEE & WILLIAM WALTER	245091004	10278.3136	0.2360	\$13,446.10	RS-2	67	1	\$3,172.71	\$1,013.76	\$800.00	\$200.00	\$4,386.47
125	481 N YORK	DENNIS TIMOTHY B & KELLY	245091005	8930.2817	0.2050	\$13,446.10	RS-2	90	1	\$2,756.80	\$1,013.76	\$800.00	\$200.00	\$3,970.36
126	481 N YORK	HILLIARD LEON E	245091006	8032.4119	0.2021	\$13,446.10	RS-2	70	1	\$2,717.44	\$1,013.76	\$800.00	\$200.00	\$3,912.20
127	464 N YORK	GONINEZ FABIOLA	245092001	8027.0143	0.1843	\$13,446.10	RS-2	70	1	\$2,477.78	\$1,013.76	\$800.00	\$200.00	\$3,691.54
128	476 N YORK	PTIGLIANO SAVERIO	245092002	7726.7915	0.1774	\$13,446.10	RS-2	70	1	\$2,395.10	\$1,013.76	\$800.00	\$200.00	\$3,598.86
129	476 N YORK	SOTO JOE & BETTY (TRS)	245092003	7611.3109	0.1793	\$13,446.10	RS-2	70	1	\$2,411.20	\$1,013.76	\$800.00	\$200.00	\$3,624.96
130	475 NEWCOMB	ALVARADO RUBEN & OBIDULIA	245092004	7679.9786	0.1753	\$13,446.10	RS-2	70	1	\$2,370.66	\$1,478.40	\$800.00	\$200.00	\$4,049.06
131	453 N NEWCOMB	VIGIL RAYMOND & SONDRICA C	245092005	7634.0091	0.1753	\$13,446.10	RS-2	70	1	\$2,356.49	\$1,478.40	\$800.00	\$200.00	\$4,034.89
132	453 N NEWCOMB	ESCOBAR MATILDE GUADALUPE CHAVEZ	245092006	7939.9091	0.1821	\$13,446.10	RS-2	70	1	\$2,446.11	\$1,478.40	\$800.00	\$200.00	\$4,126.51
133	437 N NEWCOMB	SANCHEZ JOSE N	245092007	7228.7779	0.1774	\$13,446.10	RS-2	70	1	\$2,385.72	\$1,478.40	\$800.00	\$200.00	\$4,064.12
134	1614 MORTON	SALAZAR JOSE R & CECILIA M	245092008	7635.6793	0.1759	\$13,446.10	RS-2	70	1	\$2,418.74	\$1,478.40	\$800.00	\$200.00	\$4,126.51
135	1614 MORTON	WELLS BRUN & GLORIA E	245092009	7634.0091	0.1759	\$13,446.10	RS-2	70	1	\$2,418.74	\$1,478.40	\$800.00	\$200.00	\$4,126.51
136	440 N YORK	WELLS BRUN & GLORIA E	245092010	7634.0091	0.1759	\$13,446.10	RS-2	70	1	\$2,418.74	\$1,478.40	\$800.00	\$200.00	\$4,126.51
137	440 N YORK	CI ARON ROBERT & MARIA P	245092011	7634.0091	0.1759	\$13,446.10	RS-2	70	1	\$2,418.74	\$1,478.40	\$800.00	\$200.00	\$4,126.51
138	481 N PATSY	RUBALCAVA ROGELIO G & TERESA V	245093001	9950.1524	0.2284	\$13,446.10	RS-2	90	1	\$3,071.41	\$1,013.76	\$800.00	\$200.00	\$4,285.17
139	467 N PATSY	FANNIN GREG & DORIS	245093002	8676.5018	0.1982	\$13,446.10	RS-2	70	1	\$2,678.28	\$1,013.76	\$800.00	\$200.00	\$3,692.05
140	465 N PATSY	MC ALLISTER EARNEST & DOROTHY L	245093003	8397.4980	0.1928	\$13,446.10	RS-2	70	1	\$2,592.14	\$1,013.76	\$800.00	\$200.00	\$3,605.90
141	1715 W SCHOOL	WALL BOBBY M & ELAINE A	245093004	10261.1581	0.2395	\$13,446.10	RS-2	65	1	\$3,167.41	\$1,013.76	\$800.00	\$200.00	\$4,381.17
142	1707 W SCHOOL	PERGESSON KENNETH R	245093005	17447.5518	0.4028	\$13,446.10	RS-2	65	1	\$5,416.58	\$1,013.76	\$800.00	\$200.00	\$6,630.34
143	1699 W SCHOOL	PATTON RONALD G & ROBIN A	245093006	11265.7904	0.2591	\$13,446.10	RS-2	75	1	\$3,746.94	\$1,013.76	\$800.00	\$200.00	\$4,950.70
144	1687 W SCHOOL	MYER DAVID W	245093007	11236.9445	0.2580	\$13,446.10	RS-2	75	1	\$3,463.88	\$1,013.76	\$800.00	\$200.00	\$4,697.44
145	1671 W SCHOOL	CHAMBERLAIN DEBORAH JEAN	245093008	12306.2986	0.2828	\$13,446.10	RS-2	80	1	\$3,799.33	\$1,013.76	\$800.00	\$200.00	\$4,692.38
146	1659 W SCHOOL	SMITH VIRGIL H (L EST)	245093009	7434.2792	0.1707	\$13,446.10	RS-2	80	1	\$2,284.81	\$1,013.76	\$800.00	\$200.00	\$3,508.57
147	437 N YORK	MANLEY FRANCES A	245093010	7409.5464	0.1701	\$13,446.10	RS-2	75	1	\$2,287.18	\$1,013.76	\$800.00	\$200.00	\$3,500.94
148	1662 W MORTON	FLETCHER MARION D JR & JO ANN	245093011	10186.3753	0.2341	\$13,446.10	RS-2	45	1	\$3,148.03	\$0.00	\$80.00	\$200.00	\$3,348.03
149	1704 W MORTON	CONWAY ALAN D & SUSAN M	245093012	10436.6111	0.2396	\$13,446.10	RS-2	75	1	\$3,221.07	\$2,376.00	\$80.00	\$200.00	\$5,797.57
150	1718 W MORTON	CARTER MILDRED	245093013	10661.7604	0.2448	\$13,446.10	RS-2	75	1	\$3,281.07	\$2,376.00	\$80.00	\$200.00	\$5,867.07
151	1730 W MORTON	TUMBLESON RALPH & SYLVIA D	245093014	10297.4120	0.2364	\$13,446.10	RS-2	75	1	\$3,178.60	\$2,376.00	\$80.00	\$200.00	\$5,754.60
152	1674 W MORTON	GAMMEL DONALD J	245093015	10070.5864	0.2312	\$13,446.10	RS-2	75	1	\$3,108.59	\$2,376.00	\$80.00	\$200.00	\$5,684.59
153	1674 W MORTON	WELLS VIRGINIA S	245093016	11337.8820	0.2603	\$13,446.10	RS-2	80	1	\$3,499.78	\$2,376.00	\$80.00	\$200.00	\$6,075.78
154	1665 W MORTON	THOMPSON CALVIN U & MABLE L (TRS)	245093017	10400.2260	0.2388	\$13,446.10	RS-2	75	1	\$3,210.34	\$2,376.00	\$80.00	\$200.00	\$5,786.34
155	773 ROSE	CASTRO MANUEL & ANITA	24510001	8423.7844	0.1934	\$13,446.10	RS-2	95	1	\$2,600.25	\$1,013.76	\$800.00	\$200.00	\$3,814.01
156	356 SALISBURY	BUESNOSTRO RAUL JR	24510002	95181.7065	0.9077	\$13,446.10	RS-2	169	1	\$10,669.99	\$1,013.76	\$800.00	\$200.00	\$12,073.65
157	807 ROSE	ARMAS VICTORIA	245101003	7262.2892	0.1667	\$13,446.10	RS-2	85	1	\$2,241.73	\$1,013.76	\$800.00	\$200.00	\$3,455.49

(1)	(2)	(3)	(4)	(5)	(6)	(7)	(8)	(9)	(10)	(11)	(12)	(13)	(14)	(15)
Property No.	Property Address	Owner	Assessor Parcel No.	Lot Area (SF)	Lot Area (AC)	Acreage Fee/Acre	Zoning	Lot Front Footage	Units per Lot	Acreage Fee	Sever Lateral Cost	Dumping Fee	Construction Management Cost	Total Connection Fees
155	1785 W MORTON	STONE RODNEY	245101005	13830.9824	0.3129	\$13,446.10	RS-2	80	1	\$4,207.61	\$2,376.00	\$80.00	\$200.00	\$6,763.61
156	382 SALISBURY	TORIBIO JUAN & CONSUELO	245101006	11610.9520	0.2685	\$13,446.10	RS-2	102	1	\$3,683.95	\$1,013.76	\$80.00	\$200.00	\$4,797.71
157	1772 W MORTON	ORTIZ-ROMERZEPFRAN	245101007	7231.2834	0.1660	\$13,446.10	RS-2	91	1	\$2,232.16	\$1,013.76	\$80.00	\$200.00	\$3,445.92
158	1733 W MORTON	BANK OF NEW YORK MELLON (TR) THE	245101011	10505.0682	0.2412	\$13,446.10	RS-2	76	1	\$2,942.71	\$0.00	\$80.00	\$200.00	\$3,442.71
159	1733 W MORTON	ATKINSON CAROL N (TR)	245101012	6395.8686	0.1469	\$13,446.10	RS-2	80	1	\$2,963.38	\$0.00	\$80.00	\$200.00	\$3,243.38
160	381 PATSY	BEILA BARRY D & SUZUJIE	245101013	9430.1814	0.2158	\$13,446.10	RS-2	66	1	\$2,010.10	\$1,013.76	\$80.00	\$200.00	\$3,176.14
161	381 PATSY	HERRERA JUAN & SANDRA P	245101014	9140.3784	0.2098	\$13,446.10	RS-2	62	1	\$2,010.10	\$1,013.76	\$80.00	\$200.00	\$3,223.86
162	808 N ROSE	PERALTA WALTER W (TR)	245101015	10900.5778	0.2488	\$13,446.10	RS-2	120	1	\$6,112.02	\$1,013.76	\$80.00	\$200.00	\$7,325.78
163	341 N PATSY	PERALTA WALTER W (TR)	245101016	8664.7032	0.1988	\$13,446.10	RS-2	172	1	\$2,716.84	\$1,013.76	\$80.00	\$200.00	\$3,686.40
164	760 ROSE	ZAVALA ROBERTO & CRISTINA	245101017	7511.4025	0.1724	\$13,446.10	RS-2	97	1	\$2,636.82	\$1,013.76	\$80.00	\$200.00	\$3,650.38
165	309 N PATSY	CLOVER HAWORTH A JR	245101022	5270.2068	0.1200	\$13,446.10	RS-2	66	1	\$1,668.10	\$1,013.76	\$80.00	\$200.00	\$2,761.86
166	696 ROSE	SALAZAR RAFAEL H & MARGELIA U	245101023	7605.0368	0.1748	\$13,446.10	RS-2	66	1	\$2,347.77	\$1,013.76	\$80.00	\$200.00	\$3,641.53
167	750 ROSE	ANDRADE BEJAMIN G & RUBICELIA C	245101024	7539.2027	0.1731	\$13,446.10	RS-2	90	1	\$2,327.20	\$1,013.76	\$80.00	\$200.00	\$3,641.06
168	759 ROSE	JAMIE RUBEN & ANA MARIA	245101025	7539.2027	0.1731	\$13,446.10	RS-2	90	1	\$2,327.20	\$1,013.76	\$80.00	\$200.00	\$3,641.06
169	711 ROSE	CADENA FRANK J & JANE A	245101028	12414.8837	0.2863	\$13,446.10	RS-2	148	1	\$3,830.23	\$1,013.76	\$80.00	\$200.00	\$5,044.29
170	312 N SALISBURY	IVERSEN NANCY D	245101029	12602.1614	0.2893	\$13,446.10	RS-2	148	1	\$3,830.23	\$1,013.76	\$80.00	\$200.00	\$5,044.29
171	320 SALISBURY	STANTLER RAMIRO B	245101030	10925.1970	0.2500	\$13,446.10	RS-2	50	1	\$3,390.28	\$1,013.76	\$80.00	\$200.00	\$4,604.04
172	324 SALISBURY	STANTLER MARVIN L & DARLENE	245101031	34770.4781	0.7982	\$13,446.10	RS-2	50	1	\$10,729.95	\$1,013.76	\$80.00	\$200.00	\$11,946.71
173	317 PATSY	WALKER HARRY D & ESTHER S	245101036	17184.5328	0.3922	\$13,446.10	RS-2	75	1	\$3,697.17	\$1,013.76	\$80.00	\$200.00	\$4,911.93
174	825 ROSE	MARTINEZ RAUL	245101037	11653.3918	0.2675	\$13,446.10	RS-2	110	1	\$2,028.78	\$1,013.76	\$80.00	\$200.00	\$3,242.54
175	331 PATSY	WIDMAR BETTY LOU (TR)	245101038	6575.6927	0.1510	\$13,446.10	RS-2	66	1	\$2,028.78	\$1,013.76	\$80.00	\$200.00	\$3,062.54
176	378 N PATSY	CEBALLOS JUANA	245102001	9037.1734	0.1997	\$13,446.10	RS-2	55	1	\$2,320.02	\$2,376.00	\$80.00	\$200.00	\$4,996.02
177	1683 W MORTON	SMITH GARY	245102002	7515.9407	0.1726	\$13,446.10	RS-2	70	1	\$2,284.76	\$1,013.76	\$80.00	\$200.00	\$3,502.28
178	395 N YORK	LIMON EDWARD & ROSANNE	245102005	10661.3150	0.2443	\$13,446.10	RS-2	83	1	\$2,819.41	\$1,013.76	\$80.00	\$200.00	\$4,024.17
179	395 N YORK	USA FNMA	245102007	9104.9171	0.2090	\$13,446.10	RS-2	67	1	\$2,698.94	\$1,013.76	\$80.00	\$200.00	\$3,913.70
180	331 PATSY	TURNER LLOYD & JOELLE A	245103008	9613.3561	0.2209	\$13,446.10	RS-2	65	1	\$2,728.54	\$1,013.76	\$80.00	\$200.00	\$3,942.30
181	331 PATSY	MILLS WALTER W & MELS FAM TR	245103011	4192.1049	0.0956	\$13,446.10	RS-2	52	1	\$1,598.24	\$1,013.76	\$80.00	\$200.00	\$2,612.00
182	324 N PATSY	GUTIERREZ YERONICA A	245103014	9718.2652	0.2231	\$13,446.10	RS-2	82	1	\$2,092.59	\$1,013.76	\$80.00	\$200.00	\$3,106.35
183	351 N YORK	FLORES MELISSA A	245103015	12003.2266	0.2768	\$13,446.10	RS-2	100	1	\$2,600.33	\$1,013.76	\$80.00	\$200.00	\$3,614.09
184	381 YORK	RICO JACINTO O	245103016	9684.8020	0.2228	\$13,446.10	RS-2	82	1	\$2,600.33	\$1,013.76	\$80.00	\$200.00	\$3,614.09
185	369 N YORK	SMITH DELBERT & BARBARA F	245103017	8841.3728	0.2034	\$13,446.10	RS-2	131	1	\$2,735.33	\$1,013.76	\$80.00	\$200.00	\$3,949.09
186	310 PATSY	POMBO MANUEL E & DEBORAH J	245103020	8881.3728	0.2034	\$13,446.10	RS-2	66	1	\$2,735.33	\$1,013.76	\$80.00	\$200.00	\$3,949.09
187	321 N YORK	EMERSON DAVID A & TAMARA L	245103021	9220.0011	0.2117	\$13,446.10	RS-2	66	1	\$2,735.33	\$1,013.76	\$80.00	\$200.00	\$3,949.09
188	311 YORK	DAVIS WAYNE F & LAQUITA J	245103022	10942.8918	0.2512	\$13,446.10	RS-2	72	1	\$3,377.69	\$1,013.76	\$80.00	\$200.00	\$4,591.45
189	368 PATSY	HAXTON KENNETH R & SANDRA J	245103023	9025.8294	0.2072	\$13,446.10	RS-2	60	1	\$2,786.00	\$1,013.76	\$80.00	\$200.00	\$3,999.76
190	380 N YORK	DEARMAN DAVID & SANDRA M	245103003	9030.4601	0.2073	\$13,446.10	RS-2	71	1	\$2,786.00	\$1,013.76	\$80.00	\$200.00	\$3,999.76
191	1635 W MORTON	SCHONNING SUSAN Q (TR REVOC TR)	245103004	12128.9726	0.2824	\$13,446.10	RS-2	111	1	\$3,527.50	\$1,013.76	\$80.00	\$200.00	\$4,741.26
192	1619 W MORTON	WEAVER BRENDA MARIE	245103005	9706.9630	0.2228	\$13,446.10	RS-2	110	1	\$3,527.50	\$1,013.76	\$80.00	\$200.00	\$4,741.26
193	355 NEWCOMB	VIDES BRYAN O & ERICKA NATALIA	245103009	9659.8186	0.2220	\$13,446.10	RS-2	71	1	\$2,984.88	\$1,013.76	\$80.00	\$200.00	\$4,198.64
194	347 N NEWCOMB	HOLTERMANN BRIGITTA C (EST OF)	245103010	9688.1733	0.2224	\$13,446.10	RS-2	71	1	\$2,984.88	\$1,013.76	\$80.00	\$200.00	\$4,204.31
195	337 N NEWCOMB	SCHIEPPMANN MARJORIE E (TR) (EST OF)	245103013	9844.2605	0.2283	\$13,446.10	RS-2	71	1	\$3,069.59	\$1,013.76	\$80.00	\$200.00	\$4,283.35
196	295 N NEWCOMB	BANK OF NEW YORK MELLON THE (TR)	245103014	9239.4595	0.2121	\$13,446.10	RS-2	71	1	\$2,852.04	\$1,013.76	\$80.00	\$200.00	\$4,065.80
197	302 N YORK	HERNANDEZ RICARDO	245103015	8904.8201	0.2044	\$13,446.10	RS-2	71	1	\$2,748.74	\$1,013.76	\$80.00	\$200.00	\$3,962.50
198	312 N YORK	FLOWERS DANNY LEE	245103016	9050.1038	0.2078	\$13,446.10	RS-2	71	1	\$2,793.59	\$1,013.76	\$80.00	\$200.00	\$3,987.35
199	328 N YORK	HUTCHISON SAMUEL D & CATHERINE A	245103017	9166.5543	0.2104	\$13,446.10	RS-2	71	1	\$2,773.79	\$1,013.76	\$80.00	\$200.00	\$3,987.55
200	348 YORK	MC DONNELL HOWARD R & JOYCE	245103018	9035.2228	0.2074	\$13,446.10	RS-2	71	1	\$2,768.99	\$1,013.76	\$80.00	\$200.00	\$3,987.75
201	355 N YORK	CALLAHAN TERESA L	245103020	9074.2366	0.2093	\$13,446.10	RS-2	71	1	\$2,801.03	\$1,013.76	\$80.00	\$200.00	\$4,014.79
202	260 N SALISBURY	SKILES DONALD & PAULINE	245111001	17203.7915	0.3949	\$13,446.10	RS-2	77	1	\$5,310.46	\$1,013.76	\$80.00	\$200.00	\$6,524.22
203	272 SALISBURY	LENN STEVE V	245111002	1522.9832	0.0348	\$13,446.10	RS-2	66 (AD)	1	\$5,348.71	\$1,013.76	\$80.00	\$200.00	\$6,562.47
204	283 N PATSY	ANGUANO EDGAR	245111003	15864.1769	0.3607	\$13,446.10	RS-2	68	1	\$5,103.56	\$1,013.76	\$80.00	\$200.00	\$6,317.32
205	281 N PATSY	RAMIREZ YERONICA	245111004	18317.6850	0.4235	\$13,446.10	RS-2	66	1	\$5,969.26	\$1,013.76	\$80.00	\$200.00	\$7,387.71
206	269 N PATSY	HORN RICHARD	245111005	12890.5957	0.2913	\$13,446.10	RS-2	74	1	\$3,917.53	\$1,013.76	\$80.00	\$200.00	\$5,131.09
207	219 PATSY	GONZALEZ EDUARDO	245111006	7657.3463	0.1804	\$13,446.10	RS-2	55	1	\$2,425.41	\$1,013.76	\$80.00	\$200.00	\$3,639.17
208	211 N PATSY	LOZANO LEON & MARIA	245111011	6074.1878	0.1394	\$13,446.10	RS-2	43	1	\$1,874.88	\$0.00	\$80.00	\$200.00	\$2,074.88
209	1726 W PUTNAM	BAEZ LILIA	245111012	5773.3112	0.1326	\$13,446.10	RS-2	66	1	\$1,782.11	\$2,376.00	\$80.00	\$200.00	\$4,358.11
210	1734 W PUTNAM	MC KINNEY EFFIE ELLIOTT (TR)	245111013	24210.4223	0.5568	\$13,446.10	RS-2	130	1	\$7,473.27	\$2,376.00	\$80.00	\$200.00	\$10,049.27
211	222 N SALISBURY	CASTILLO DAMAZO J & MARTHA H	245111015	17185.8579	0.3945	\$13,446.10	RS-2	78	1	\$5,304.93	\$1,013.76	\$80.00	\$200.00	\$6,518.69
212	234 SALISBURY	PEER TIMOTHY M	245111016	8715.4191	0.2001	\$13,446.10	RS-2	77	1	\$2,690.28	\$1,013.76	\$80.00	\$200.00	\$3,904.04
213	234 N SALISBURY	NINOBLA ARCADIO P & LYDIA ALOOT	245111017	8634.2860	0.1982	\$13,446.10	RS-2	77	1	\$2,680.23	\$1,013.76	\$80.00	\$200.00	\$3,874.99
214	246 N SALISBURY	STATLER MARVIN L & ANNA D	245111018	16955.4746	0.3892	\$13,446.10	RS-2	77	1	\$5,233.92	\$1,013.76	\$80.00	\$200.00	\$6,447.68

(1)	(2)	(3)	(4)	(5)	(6)	(7)	(8)	(9)	(10)	(11)	(12)	(13)	(14)	(15)
Property No.	Property Address	Owner	Assessor Parcel No.	Lot Area (SF)	Lot Area (AC)	Acreage Fee/Acre	Zoning	Lot Front Footage	Units per Lot	Acres Fee	Sewer Lateral Cost	Plumbing & Electrical	Construction Management Cost	Total Connection Fees
234	235 N SALISBURY	CORTIZO JOE & ANA I	245111019	22863.3558	0.5248	\$13,446.10	RS-2	101	1	\$7,058.53	\$1,013.76	\$800.00	\$200.00	\$8,270.29
235	236 N SALISBURY	PANAGLIA ARTURO AVILA	23935.1658	0.5495	\$13,446.10	RS-2	108	1	1	\$7,388.32	\$1,013.76	\$800.00	\$200.00	\$8,602.08
236	210 N SALISBURY	THOMAS LESLIE J	245111023	8263.7244	0.1902	\$13,446.10	RS-2	55	1	\$2,557.02	\$1,013.76	\$800.00	\$200.00	\$3,770.78
237	1755 PUTNAM	GARCIA RAUL & CARMEN	245111024	9156.2078	0.2102	\$13,446.10	RS-2	115	1	\$2,826.96	\$1,013.76	\$800.00	\$200.00	\$4,042.72
238	261 N PATSY	STATLER MARVIN	23817.9216	0.5422	\$13,446.10	RS-2	66	1	1	\$7,290.38	\$1,013.76	\$800.00	\$200.00	\$8,504.14
239	243 N PATSY	STATLER MARVIN & ANNA D	245111025	35441.4416	0.8136	\$13,446.10	RS-2	132	1	\$10,940.06	\$1,013.76	\$800.00	\$200.00	\$12,154.82
240	266 PATSY	MARTINEZ RICARDO	15185.3950	0.3486	\$13,446.10	RS-2	55	1	1	\$3,691.42	\$1,013.76	\$800.00	\$200.00	\$5,901.18
241	254 N PATSY	HUERTAZ RAFAEL & LUCIA H	245112004	8978.6279	0.2053	\$13,446.10	RS-2	66	1	\$3,029.33	\$1,013.76	\$800.00	\$200.00	\$4,243.09
242	255 N YORK	ARTHUR DALE E & CAROLYN S	245112005	8079.5225	0.1855	\$13,446.10	RS-2	66	1	\$2,493.68	\$1,013.76	\$800.00	\$200.00	\$3,707.44
243	1655 W PUTNAM	MULLINS RANDY R & JAN	245112009	11462.1172	0.2631	\$13,446.10	RS-2	91	1	\$3,543.18	\$1,013.76	\$800.00	\$200.00	\$5,114.13
244	1676 W PUTNAM	LONG BILL B & RHONDA J	245112010	8010.2857	0.1839	\$13,446.10	RS-2	80	1	\$2,472.61	\$1,013.76	\$800.00	\$200.00	\$3,750.53
245	233 N YORK	STATLER MARVIN L	245112011	8118.1108	0.1877	\$13,446.10	RS-2	83	1	\$2,536.77	\$1,013.76	\$800.00	\$200.00	\$3,750.53
246	235 N YORK	GREEN MARVIN L & HELEN (TRS)	245112013	16414.2939	0.3760	\$13,446.10	RS-2	132	1	\$5,065.75	\$1,013.76	\$800.00	\$200.00	\$6,280.51
247	246 N PATSY	TRUJILLO ENRIQUE	245112016	8949.5599	0.2078	\$13,446.10	RS-2	66	1	\$2,749.32	\$1,013.76	\$800.00	\$200.00	\$4,163.42
248	251 N YORK	SANDERSON BONNIE L	245112017	9530.8132	0.2188	\$13,446.10	RS-2	66	1	\$2,943.97	\$1,013.76	\$800.00	\$200.00	\$4,155.73
249	256 N PATSY	SALINAS ROEL & ROSE E	245112018	8945.9268	0.2031	\$13,446.10	RS-2	66	1	\$2,780.56	\$1,013.76	\$800.00	\$200.00	\$4,003.32
250	235 YORK	BAKTELIT RICHARD W	245112019	9233.0600	0.2120	\$13,446.10	RS-2	66	1	\$2,850.08	\$1,013.76	\$800.00	\$200.00	\$4,063.84
251	236 YORK	VILLALBOS MARCO DE JERUS	245112020	9636.9570	0.2202	\$13,446.10	RS-2	66	1	\$2,983.36	\$1,013.76	\$800.00	\$200.00	\$4,197.12
252	282 N PATSY	HUGHES LESLIE G	245112022	8611.0519	0.1963	\$13,446.10	RS-2	66	1	\$2,760.21	\$1,013.76	\$800.00	\$200.00	\$3,973.97
253	252 N PATSY	BRINKMAN GREG M	245112023	7245.0319	0.1662	\$13,446.10	RS-2	66	1	\$2,037.05	\$1,013.76	\$800.00	\$200.00	\$3,250.81
254	253 N PATSY	LEMBKE LES D & LOIS M (TRS)	245112024	6653.1389	0.1516	\$13,446.10	RS-2	77	1	\$2,037.05	\$1,013.76	\$800.00	\$200.00	\$3,250.81
255	254 N PATSY	SWANER ESQUEL & ARCELA	245112025	9661.6657	0.2218	\$13,446.10	RS-2	66	1	\$2,892.36	\$1,013.76	\$800.00	\$200.00	\$4,106.12
256	224 N YORK	LIPP MORTGAGE LP	245112026	6635.4994	0.1521	\$13,446.10	RS-2	66	1	\$2,037.05	\$1,013.76	\$800.00	\$200.00	\$3,250.81
257	223 N YORK	GUTIERREZ AGUSTIN DIAZ	245113001	8713.7281	0.2000	\$13,446.10	RS-2	66	1	\$2,686.61	\$1,013.76	\$800.00	\$200.00	\$3,973.97
258	255 N YORK	MOWLES JUNE L	245113002	8650.0446	0.2055	\$13,446.10	RS-2	71	1	\$2,762.70	\$1,013.76	\$800.00	\$200.00	\$3,973.97
259	270 N YORK	GONZALEZ JOSE G & ARACELI	245113003	8890.6577	0.2064	\$13,446.10	RS-2	71	1	\$2,775.30	\$1,013.76	\$800.00	\$200.00	\$3,989.06
260	284 N YORK	MARTINEZ ROSS A	245113004	9008.1659	0.2068	\$13,446.10	RS-2	71	1	\$2,780.64	\$1,013.76	\$800.00	\$200.00	\$3,994.40
261	260 N YORK	SANDOVAL JOSE P & VIRGINIA G	245113005	9651.9475	0.2216	\$13,446.10	RS-2	71	1	\$2,979.36	\$1,013.76	\$800.00	\$200.00	\$4,193.12
262	263 N NEWCOMB	SEHER CHRISTOPHER B & SARAH A	245113006	9599.7895	0.2204	\$13,446.10	RS-2	71	1	\$2,963.26	\$1,013.76	\$800.00	\$200.00	\$4,177.02
263	265 N NEWCOMB	BRAVO JOSE	245113007	9460.7663	0.2172	\$13,446.10	RS-2	71	1	\$2,920.35	\$1,013.76	\$800.00	\$200.00	\$4,134.11
264	257 N NEWCOMB	SUE ROLAND G	245113008	9411.9115	0.2161	\$13,446.10	RS-2	71	1	\$2,905.27	\$1,013.76	\$800.00	\$200.00	\$4,134.11
265	249 N NEWCOMB	GARCIA VICTOR M & ROSEMARY	245113009	11935.5931	0.2740	\$13,446.10	RS-2	110	1	\$3,684.28	\$1,013.76	\$800.00	\$200.00	\$4,898.04
266	1610 W PUTNAM	LOUIS RICHARD DANIEL & KONI JEAN	245113012	11033.3821	0.2533	\$13,446.10	RS-2	110	1	\$3,405.78	\$1,013.76	\$800.00	\$200.00	\$4,609.54
267	1636 W PUTNAM	WARD WILLIAM R & RITA I (TRS)FAM T	245113013	8918.1658	0.2047	\$13,446.10	RS-2	110	1	\$2,752.86	\$1,013.76	\$800.00	\$200.00	\$3,966.62
271	238 N YORK	KRALOWEC DONNA M	245113014	9124.0557	0.2095	\$13,446.10	RS-2	71	1	\$2,816.41	\$1,013.76	\$800.00	\$200.00	\$4,030.17
272	238 N YORK	MORA THERESA	245113015	8649.6532	0.1979	\$13,446.10	RS-2	71	1	\$2,731.71	\$1,013.76	\$800.00	\$200.00	\$3,945.47
273	248 N YORK	GIL JUVENAL & GRISELDA	245113016	7311.9599	0.1679	\$13,446.10	RS-2	102	1	\$2,256.93	\$1,013.76	\$800.00	\$200.00	\$3,270.69
274	1745 TOMAH	ARRIOLA ALBINO G	245120002	8126.4021	0.1866	\$13,446.10	RS-2	70	1	\$2,508.46	\$1,013.76	\$800.00	\$200.00	\$3,522.22
275	1731 W TOMAH	JENSEN WILLIAM E & CAROL M	245120003	8321.8621	0.1900	\$13,446.10	RS-2	70	1	\$2,598.51	\$1,013.76	\$800.00	\$200.00	\$3,602.27
276	1719 W TOMAH	WILLIAMS JAMES R	245120004	8521.6594	0.1956	\$13,446.10	RS-2	70	1	\$2,658.13	\$1,013.76	\$800.00	\$200.00	\$3,671.89
277	751 PATSY	CARDILLO THOMAS & ROSA M	245120005	9521.6594	0.2186	\$13,446.10	RS-2	90	1	\$2,835.13	\$1,013.76	\$800.00	\$200.00	\$4,048.89
278	64 PATSY	VICKERS LC & RESA	245120006	23304.9593	0.5350	\$13,446.10	RS-2	90	1	\$7,193.77	\$1,013.76	\$800.00	\$200.00	\$8,407.53
279	76 PATSY	CASTANON OLSBALDO & EVELINA	245120007	6591.1642	0.1521	\$13,446.10	RS-2	94	1	\$2,037.05	\$1,013.76	\$800.00	\$200.00	\$3,250.81
280	1633 W TOMAH	JACKSON TERESA E	245120008	9438.3300	0.2167	\$13,446.10	RS-2	94	1	\$2,813.42	\$1,013.76	\$800.00	\$200.00	\$4,127.18
281	1657 W TOMAH	JIMENEZ JOE LUIS	245120009	9575.2321	0.2198	\$13,446.10	RS-2	115	1	\$2,955.68	\$1,013.76	\$800.00	\$200.00	\$4,169.44
282	75 N YORK	MENDEZ MARTIN	245120010	9619.4191	0.2208	\$13,446.10	RS-2	70	1	\$2,969.32	\$1,013.76	\$800.00	\$200.00	\$4,183.08
283	69 N YORK	REYES RUBEN & GUADALUPE	245120011	8665.5900	0.1989	\$13,446.10	RS-2	60	1	\$2,674.89	\$1,013.76	\$800.00	\$200.00	\$3,688.65
284	61 N YORK	WAGNER WAYNE L & REGINAL (TRS)	245120012	10778.6484	0.2474	\$13,446.10	RS-2	41	1	\$3,327.15	\$1,013.76	\$800.00	\$200.00	\$4,540.91
285	39 YORK	LARA RAFAEL	245120014	9697.1968	0.2226	\$13,446.10	RS-2	60	1	\$2,993.33	\$1,013.76	\$800.00	\$200.00	\$4,207.09
287	38 YORK	JOINER LAWRENCE R & JUDY	245120017	7689.9430	0.1811	\$13,446.10	RS-2	60	1	\$2,435.47	\$1,013.76	\$800.00	\$200.00	\$3,649.23
288	70 N YORK	LUNA JUAN & SONIA	245120018	9183.4667	0.2108	\$13,446.10	RS-2	70	1	\$2,634.75	\$1,013.76	\$800.00	\$200.00	\$3,648.51
289	1631 W TOMAH	MARTINEZ FABOLA	245120019	9207.3054	0.2114	\$13,446.10	RS-2	110	1	\$2,842.11	\$1,013.76	\$800.00	\$200.00	\$4,048.87
291	91 N NEWCOMB	MENCHAGA JOHN & OCTAVIANA	245120021	9466.9794	0.2178	\$13,446.10	RS-2	110	1	\$2,928.44	\$1,013.76	\$800.00	\$200.00	\$4,142.20
292	85 N NEWCOMB	ESPINOZA FLORENCIO	245120022	9341.7514	0.2145	\$13,446.10	RS-2	70	1	\$2,863.61	\$1,013.76	\$800.00	\$200.00	\$4,067.37
293	71 N NEWCOMB	STURGEON TRACY W & JUDY E	245120024	9059.4733	0.2080	\$13,446.10	RS-2	70	1	\$2,796.48	\$1,013.76	\$800.00	\$200.00	\$3,949.24
294	63 N NEWCOMB	OLBERA PRISCILLA A	245120025	9064.8758	0.2081	\$13,446.10	RS-2	70	1	\$2,798.15	\$1,013.76	\$800.00	\$200.00	\$3,951.91
295	51 N NEWCOMB	SEMPLER DEAN B & JOY D (CO-TRS)	245120034	10868.2321	0.2408	\$13,446.10	RS-2	40	1	\$3,330.43	\$1,013.76	\$800.00	\$200.00	\$4,476.55
297	60 N YORK	GOVEA MOISES	245120035	10736.2894	0.2477	\$13,446.10	RS-2	40	1	\$3,330.43	\$1,013.76	\$800.00	\$200.00	\$4,544.19
320	1819 W MORTON	TAPIA JOSE	245130001	7075.7394	0.1624	\$13,446.10	RS-2	112	1	\$2,184.14	\$1,013.76	\$800.00	\$200.00	\$3,267.90
321	1805 W MORTON	BOWLES JUDITH A	245130002	6362.7613	0.1461	\$13,446.10	RS-2	86	1	\$1,954.06	\$1,013.76	\$800.00	\$200.00	\$2,968.14
323	345 N SALISBURY	BELTRAN ARMANDO	245130005	17940.4759	0.4027	\$13,446.10	RS-2	77	1	\$5,414.40	\$1,013.76	\$800.00	\$200.00	\$6,628.16
324	329 N SALISBURY	STATLER MARVIN LEO	245130006	17440.4939	0.4009	\$13,446.10	RS-2	77	1	\$5,385.18	\$1,013.76	\$800.00	\$200.00	\$6,589.94
325	307 N SALISBURY	EMERSONIAN ERIK E	245130007	17459.8221	0.4009	\$13,446.10	RS-2	77	1	\$5,385.				

(1)	(2)	(3)	(4)	(5)	(6)	(7)	(8)	(9)	(10)	(11)	(12)	(13)	(14)	(15)
Property No.	Property Address	Owner	Assessor Parcel No.	Lot Area (SF)	Lot Area (AC)	Acreage Fee/Acre	Zoning	Lot Frontage	Units per Lot	Acreage Fee	Sewer Lateral Cost	Allocating Fund	Construction Management Cost	Total Connection Fees
372	265 N SALISBURY	HERNANDEZ RAMIRO B	245143012	1724.2734	0.3956	\$13,446.10	RS-2	77	1	\$5,319.88	\$1,013.76	\$800.00	\$200.00	\$6,533.64
373	265 N SALISBURY	RANSFORD FREDO	245143013	1723.1039	0.3956	\$13,446.10	RS-2	77	1	\$5,319.88	\$1,013.76	\$800.00	\$200.00	\$6,533.64
374	269 N SALISBURY	GREGG CHARLES JR & EDITH	245143014	1723.9223	0.3956	\$13,446.10	RS-2	77	1	\$5,319.88	\$1,013.76	\$800.00	\$200.00	\$6,533.64
375	237 N SALISBURY	SANCHEZ ANGELINA	245143015	8615.3929	0.1978	\$13,446.10	RS-2	77	1	\$2,659.40	\$1,013.76	\$800.00	\$200.00	\$3,873.16
376	247 N SALISBURY	MORON BEDOLLA EFRAIN	245143016	8615.3779	0.1978	\$13,446.10	RS-2	77	1	\$2,659.40	\$1,013.76	\$800.00	\$200.00	\$3,873.16
377	233 N SALISBURY	RODRIGUEZ ALEJANDRO & JESSICA TRS	245143017	17229.5993	0.3985	\$13,446.10	RS-2	77	1	\$5,319.43	\$1,013.76	\$800.00	\$200.00	\$6,532.19
378	223 N SALISBURY	LONG LARRY D LIVING TRS	245143018	17475.7233	0.4013	\$13,446.10	RS-2	78	1	\$5,319.43	\$1,013.76	\$800.00	\$200.00	\$6,532.19
379	1816 W PUTNAM	GARCIA VICTOR M & ROSEMARY	245143020	9893.0335	0.2294	\$13,446.10	RS-2	122	1	\$3,398.64	\$1,013.76	\$800.00	\$200.00	\$5,009.40
380	209 N SALISBURY	GARCIA VICTOR M & ROSEMARY	245143020	9893.0335	0.2294	\$13,446.10	RS-2	122	1	\$3,398.64	\$1,013.76	\$800.00	\$200.00	\$5,009.40
386	185 N BELMONT	NONOROS JEAN P & NANCY F	245161001	8034.1325	0.1844	\$13,446.10	RS-2	72	1	\$2,144.25	\$0.00	\$800.00	\$200.00	\$2,944.25
397	171 N BELMONT	GEMMELL JEFFREY & JANET	245161002	8388.5301	0.1926	\$13,446.10	RS-2	72	1	\$2,144.25	\$0.00	\$800.00	\$200.00	\$2,944.25
398	1848 W CHERRY	SPEEGLE GEORGIA M	245161003	8318.4514	0.1910	\$13,446.10	RS-2	72	1	\$2,099.37	\$0.00	\$800.00	\$200.00	\$2,899.37
399	1855 W CHERRY	ORTIZ OLGA ALICIA & UBALDO JR	245161004	8329.1517	0.1912	\$13,446.10	RS-2	72	1	\$2,099.37	\$0.00	\$800.00	\$200.00	\$2,899.37
400	1868 W CHERRY	LOPEZ MIGUEL & REYNALDA	245161005	8326.8228	0.1912	\$13,446.10	RS-2	72	1	\$2,099.37	\$0.00	\$800.00	\$200.00	\$2,899.37
401	1878 W CHERRY	U S BANK NA (TRS)	245161006	8070.9684	0.1853	\$13,446.10	RS-2	70	1	\$2,491.35	\$1,013.76	\$800.00	\$200.00	\$3,705.11
402	1888 W CHERRY	LEWIS DOUGLAS R & NANCY N	245161007	8071.4950	0.1807	\$13,446.10	RS-2	70	1	\$2,491.35	\$1,013.76	\$800.00	\$200.00	\$3,705.11
403	1898 W CHERRY	SWEET TAMARA	245161008	8198.0578	0.1882	\$13,446.10	RS-2	70	1	\$2,491.35	\$1,013.76	\$800.00	\$200.00	\$3,705.11
404	1908 W CHERRY	DOROUGH BILLY W & PATSY (TRS)	245161009	7983.4424	0.1824	\$13,446.10	RS-2	70	1	\$2,491.35	\$1,013.76	\$800.00	\$200.00	\$3,705.11
405	1918 W CHERRY	CABRERA MIGUEL & MARTY L	245161010	8189.4624	0.1815	\$13,446.10	RS-2	70	1	\$2,491.35	\$1,013.76	\$800.00	\$200.00	\$3,705.11
406	1928 W CHERRY	WALSH JOHN & MARY	245161011	8080.4825	0.1855	\$13,446.10	RS-2	70	1	\$2,491.35	\$1,013.76	\$800.00	\$200.00	\$3,705.11
407	1938 W CHERRY	ARONDAIRINK & TRACY ARDEN	245161012	8080.4825	0.1855	\$13,446.10	RS-2	70	1	\$2,491.35	\$1,013.76	\$800.00	\$200.00	\$3,705.11
408	1948 W CHERRY	CRAMPTON LOYD EARL & SHERRY L	245161013	7823.4139	0.1798	\$13,446.10	RS-2	68	1	\$2,414.83	\$1,013.76	\$800.00	\$200.00	\$3,428.59
409	1958 W CHERRY	RODRIGUEZ RAFAEL V & MARIA	245161014	13245.6003	0.3041	\$13,446.10	RS-2	68	1	\$4,098.85	\$1,013.76	\$800.00	\$200.00	\$5,312.61
410	161 N WALCH	REED STEVEN B & JILL E	245161015	13245.6003	0.3041	\$13,446.10	RS-2	68	1	\$4,098.85	\$1,013.76	\$800.00	\$200.00	\$5,312.61
411	151 WALCH	GREEN MATT HEW L	245161016	9286.2588	0.2134	\$13,446.10	RS-2	43	1	\$2,859.57	\$1,013.76	\$800.00	\$200.00	\$4,073.33
412	141 WALCH	GONZALEZ JOHNNY & ROSIE	245161017	8616.5441	0.1978	\$13,446.10	RS-2	42	1	\$2,859.57	\$1,013.76	\$800.00	\$200.00	\$4,073.33
413	131 N WALCH	SERRANO EVA M	245161018	9311.4021	0.2138	\$13,446.10	RS-2	71	1	\$2,897.01	\$1,013.76	\$800.00	\$200.00	\$3,910.77
414	188 N BELMONT	CEBALLOS JOSE TRINIDAD CORONA	245162001	9077.3166	0.2084	\$13,446.10	RS-2	58	1	\$2,801.99	\$0.00	\$800.00	\$200.00	\$3,001.99
415	1818 W CHERRY	RODRIGUEZ ANGEL G & JUANITA B	245162002	9415.6422	0.2162	\$13,446.10	RS-2	102	1	\$2,906.42	\$1,013.76	\$800.00	\$200.00	\$4,120.18
416	1805 W CHERRY	CORTEZ LEO S & ELVA G	245162003	9624.5299	0.2209	\$13,446.10	RS-2	56	1	\$2,970.90	\$1,013.76	\$800.00	\$200.00	\$4,184.66
417	1805 W PUTNAM	MEZA ALFREDO B	245162004	9624.5299	0.2209	\$13,446.10	RS-2	56	1	\$2,970.90	\$1,013.76	\$800.00	\$200.00	\$4,184.66
418	1797 W CHERRY	GARCIA RAUL & CARMEN	245162005	9966.8632	0.2288	\$13,446.10	RS-2	68	1	\$3,076.57	\$1,013.76	\$800.00	\$200.00	\$4,286.33
419	1797 W CHERRY	U S BANK NA	245162006	10201.1430	0.2342	\$13,446.10	RS-2	68	1	\$3,148.89	\$1,013.76	\$800.00	\$200.00	\$4,362.65
420	1784 W CHERRY	GARCIA RAUL & CARMEN	245162007	10795.4502	0.2389	\$13,446.10	RS-2	70	1	\$3,148.89	\$1,013.76	\$800.00	\$200.00	\$4,362.65
421	1784 W CHERRY	PEREZ JOSE M & ROSA	245162008	9969.6592	0.2289	\$13,446.10	RS-2	68	1	\$3,148.89	\$1,013.76	\$800.00	\$200.00	\$4,362.65
422	1769 W PUTNAM	GARCIA RAUL & CARMEN	245162009	17095.0712	0.3713	\$13,446.10	RS-2	94	1	\$5,354.55	\$0.00	\$800.00	\$200.00	\$6,154.55
423	1776 W CHERRY	ANDERSON DENNIS & JUDY	245162010	12977.1895	0.2987	\$13,446.10	RS-2	140	1	\$4,123.00	\$1,013.76	\$800.00	\$200.00	\$5,136.76
424	178 W SALISBURY	VASQUEZ LINDA	245162011	12977.1895	0.2987	\$13,446.10	RS-2	140	1	\$4,123.00	\$1,013.76	\$800.00	\$200.00	\$5,136.76
425	180 W SALISBURY	THOMPSON ROBERT A & CAMILE	245162012	10065.5841	0.2287	\$13,446.10	RS-2	97	1	\$3,148.89	\$1,013.76	\$800.00	\$200.00	\$4,362.65
426	1764 W TOMAH	GUTIERREZ RODOLFO A & KATHY D	245162014	10409.5443	0.2330	\$13,446.10	RS-2	64	1	\$2,958.22	\$1,013.76	\$800.00	\$200.00	\$3,971.98
427	88 N SALISBURY	LANDUCCI FRED M & ALISON M (TRS)	245163003	9681.8512	0.2271	\$13,446.10	RS-2	103	1	\$3,098.66	\$1,013.76	\$800.00	\$200.00	\$4,209.42
428	1837 TOMAH	MITCHELL JOE MAXWELL	245164001	11884.2278	0.2682	\$13,446.10	RS-2	100	1	\$3,098.66	\$1,013.76	\$800.00	\$200.00	\$4,209.42
429	1821 W TOMAH	NEWMAN DARLENE	245164002	10084.2823	0.2287	\$13,446.10	RS-2	100	1	\$3,098.66	\$1,013.76	\$800.00	\$200.00	\$4,209.42
430	1813 TOMAH	PEREZ MAXIMO J & MARY VIRGINIA	245164003	9373.5291	0.2174	\$13,446.10	RS-2	83	1	\$2,893.25	\$1,013.76	\$800.00	\$200.00	\$3,907.01
431	1791 TOMAH	PEREZ MAXIMO J & MARY VIRGINIA	245164004	9470.2929	0.2174	\$13,446.10	RS-2	83	1	\$2,893.25	\$1,013.76	\$800.00	\$200.00	\$3,907.01
432	1813 TOMAH	PEREZ MAXIMO J & MARY VIRGINIA	245164005	11128.8134	0.2555	\$13,446.10	RS-2	78	1	\$3,436.24	\$0.00	\$800.00	\$200.00	\$4,236.24
433	91 SALISBURY	BLUDD CHARLES L & JO ANN	245165001	9051.9810	0.2078	\$13,446.10	RS-2	115	1	\$2,794.17	\$1,013.76	\$800.00	\$200.00	\$3,807.93
434	1839 W CHERRY	CAPARK ROY J & JO ELLEN	245165002	9291.1073	0.2133	\$13,446.10	RS-2	87	1	\$2,867.98	\$1,013.76	\$800.00	\$200.00	\$3,881.74
435	1840 W TOMAH	TAPIA SALVADOR MANUEL	245165003	8527.7708	0.1958	\$13,446.10	RS-2	56	1	\$2,929.27	\$1,013.76	\$800.00	\$200.00	\$3,943.03
436	1825 W CHERRY	CALUK JOHN L & CAROL A	245165004	9489.6669	0.2179	\$13,446.10	RS-2	87	1	\$2,745.55	\$1,013.76	\$800.00	\$200.00	\$3,759.32
437	1828 W TOMAH	VIDRIO DAVID A & MARIA C	245165005	8894.5182	0.2042	\$13,446.10	RS-2	83	1	\$2,936.35	\$1,013.76	\$800.00	\$200.00	\$3,950.11
438	1813 W CHERRY	CAMARENA FRED J	245165006	9512.6434	0.2184	\$13,446.10	RS-2	78	1	\$2,717.59	\$1,013.76	\$800.00	\$200.00	\$3,731.35
439	1816 W TOMAH	JAMES JOSHUA C & SARAH L	245165007	8903.8952	0.2021	\$13,446.10	RS-2	80	1	\$2,936.35	\$1,013.76	\$800.00	\$200.00	\$3,950.11
440	1801 W CHERRY	ESCALERA JUAN V	245165008	9504.5680	0.2182	\$13,446.10	RS-2	78	1	\$2,936.35	\$1,013.76	\$800.00	\$200.00	\$3,950.11
441	1804 W TOMAH	GOUCHER BILLY G & DARLENE (TRS)	245165009	9703.7640	0.2228	\$13,446.10	RS-2	80	1	\$2,996.35	\$1,013.76	\$800.00	\$200.00	\$4,006.11
442	1804 W TOMAH	BRAZELL JOHNNY	245165010	10517.4608	0.2414	\$13,446.10	RS-2	111	1	\$2,996.35	\$1,013.76	\$800.00	\$200.00	\$4,006.11
443	1804 W TOMAH	CONTRERAS BERTHA	245165011	9328.3547	0.2111	\$13,446.10	RS-2	87	1	\$2,996.35	\$1,013.76	\$800.00	\$200.00	\$4,006.11
444	1888 W CHERRY	RIVERA THOMAS & HEATHER	245165012	9296.3442	0.1985	\$13,446.10	RS-2	73	1	\$2,659.40	\$1,013.76	\$800.00	\$200.00	\$3,673.16
445	1859 W CHERRY	LAVINE S (TRS) BELLA	245165013	8515.5927	0.1955	\$13,446.10	RS-2	73	1	\$2,659.40	\$1,013.76	\$800.00	\$200.00	\$3,673.16
446	1859 W CHERRY	CASSELL BERTHA	245165014	8515.5927	0.1955	\$13,446.10	RS-2	73	1	\$2,659.40	\$1,013.76	\$800.00	\$200.00	\$3,673.16
447	1837 W CHERRY	DUNGAN JANCE B (TR)	245165015	8373.9581	0.1922	\$13,446.10	RS-2	73	1	\$2,599.40	\$1,013.76	\$800.00	\$200.00	\$3,613.16
448	1859 W CHERRY	GONZALEZ JUAN F & LINDA R	245165016	8414.6533	0.1922	\$13,446.10	RS-2	73	1	\$2,599.40	\$1,013.76	\$800.00	\$200.00	\$3,613.

(1) Property No.	(2) Property Address	(3) Owner	(4) Assessor Parcel No.	(5) Lot Area (SF)	(6) Lot Area (AC)	(7) Acreage Fee/Acre	(8) Zoning	(9) Lot Front Footage	(10) Units per Lot	(11) Acreage Fee	(12) Sewer Lateral Cost	(13) Right-of-Way Cost	(14) Construction Management Cost	(15) Total Connection Fees
456	1928 W TOMAH	WALKER DOCK & VELMA (TRS)	245165022	8825.4095	0.1980	\$13,446.10	RS-2	75	1	\$2,692.45	\$1,013.76	\$300.00	\$200.00	\$3,876.26
457	1918 W TOMAH	MANNING ELIZABETH J	245165023	8991.0821	0.1980	\$13,446.10	RS-2	75	1	\$2,692.45	\$1,013.76	\$300.00	\$200.00	\$3,876.26
458	1908 W TOMAH	VAUGHN RUTH ELIZABETH (TR)	245165024	8975.2916	0.1946	\$13,446.10	RS-2	73	1	\$2,615.92	\$1,013.76	\$300.00	\$200.00	\$3,794.68
459	1898 W TOMAH	NEWBERG DANIELA & BETTY A	245165025	8649.2916	0.1946	\$13,446.10	RS-2	73	1	\$2,615.92	\$1,013.76	\$300.00	\$200.00	\$3,794.68
460	1888 W TOMAH	RODGUEZ HENRY	245165027	8824.4382	0.1923	\$13,446.10	RS-2	73	1	\$2,602.76	\$1,013.76	\$300.00	\$200.00	\$3,834.54
461	1878 W TOMAH	BLAZERMAN LEO	245165028	8374.6157	0.1823	\$13,446.10	RS-2	73	1	\$2,665.08	\$1,013.76	\$300.00	\$200.00	\$3,875.95
462	1868 W TOMAH	DUFF MARILO	245165029	8494.8504	0.1950	\$13,446.10	RS-2	73	1	\$2,692.47	\$1,013.76	\$300.00	\$200.00	\$3,835.95
463	1858 W TOMAH	KAMRATH WAYNE L & JO ANN	245165030	8528.1411	0.1958	\$13,446.10	RS-2	73	1	\$2,692.47	\$1,013.76	\$300.00	\$200.00	\$3,846.23
464	1848 W TOMAH	DOFFLEAVEY PEGGY J	251271001	8696.6636	0.1958	\$13,446.10	RS-2	73	1	\$2,692.47	\$1,013.76	\$300.00	\$200.00	\$3,846.23
465	1838 W TOMAH	MARTINEZ DE ANDRADO & NORMA	251271002	8150.0383	0.1873	\$13,446.10	RS-2	45	1	\$2,618.53	\$1,013.76	\$300.00	\$200.00	\$3,329.29
466	1828 W TOMAH	CHIFFAMBI LIMITED PARTNERSHIP	251271003	8315.5186	0.1909	\$13,446.10	RS-2	110	1	\$2,666.83	\$1,013.76	\$300.00	\$200.00	\$3,266.83
467	1818 W TOMAH	CHRISTENSEN ANNE R (TR)	251271007	8160.8517	0.1873	\$13,446.10	RS-2	107	1	\$2,619.09	\$1,013.76	\$300.00	\$200.00	\$3,332.85
468	1808 W TOMAH	LIKINS THOMAS E	251271021	39106.0853	0.8678	\$13,446.10	RS-2	43	1	\$12,071.27	\$2,376.00	\$800.00	\$200.00	\$14,647.27
469	69 N LOTAS	ALVARADO JOSE L & DOLORES	251291007	20347.2915	0.4671	\$13,446.10	RS-2	80	1	\$6,281.01	\$1,013.76	\$800.00	\$200.00	\$7,494.77
470	68 N LOTAS	BLEVINS IRENE & PAT	251291008	20603.0219	0.4730	\$13,446.10	RS-2	100	1	\$6,359.82	\$1,013.76	\$800.00	\$200.00	\$7,573.58
471	82 N NEWCOMB	KLEIN RAMER PAUL & JANE	251291014	8205.5841	0.1876	\$13,446.10	RM-2	100	1	\$2,521.86	\$1,013.76	\$800.00	\$200.00	\$4,200.26
472	60 NEWCOMB	ROSS HILDA	251291020	8046.3295	0.1842	\$13,446.10	RM-2	50	1	\$2,532.90	\$1,013.76	\$800.00	\$200.00	\$3,466.56
473	1565 W TOMAH	LEDESMA LUIS JOSE	251291022	8046.3295	0.1842	\$13,446.10	RM-2	50	1	\$2,532.90	\$1,013.76	\$800.00	\$200.00	\$3,466.56
474	1573 W TOMAH	DAVIDSON RONALD E (EST OF)	251291023	8094.8889	0.1847	\$13,446.10	RM-2	84	1	\$2,611.53	\$1,013.76	\$800.00	\$200.00	\$3,265.29
475	1565 W TOMAH	MORA ARMANDO H & MARI GRACE O	251291033	6005.0538	0.1399	\$13,446.10	RM-2	80	1	\$2,483.82	\$0.00	\$800.00	\$200.00	\$2,683.82
476	1555 W TOMAH	ARCE MARIO	251291034	6005.0538	0.1379	\$13,446.10	RM-2	65	1	\$1,881.37	\$1,013.76	\$800.00	\$200.00	\$3,065.13
1000	87 N LOTAS	CARMONA JOSE LUIS BEARRA & ANA MARI	251291035	6477.8888	0.1487	\$13,446.10	RM-2	65	1	\$1,863.64	\$0.00	\$800.00	\$200.00	\$2,063.64
1001	52 N LOTAS	MENDEZ ERACLIO & BEATRIZ	251292001	9977.5286	0.2291	\$13,446.10	RM-2	76	1	\$1,999.59	\$1,013.76	\$800.00	\$200.00	\$2,199.59
1002	56 N LOTAS	BUENROSTRO RAUL P & AMELIA	251292002	10261.5286	0.2291	\$13,446.10	RM-2	50	1	\$3,079.95	\$1,013.76	\$800.00	\$200.00	\$4,293.67
1003	56 N LOTAS	DAVIDSON RONALD E (EST OF)	251292003	9774.2799	0.2244	\$13,446.10	RM-2	50	1	\$3,079.95	\$1,013.76	\$800.00	\$200.00	\$4,293.67
1004	1625 W TOMAH	MEERS GARY W	251292005	11989.9952	0.2795	\$13,446.10	RM-2	50	1	\$3,079.95	\$1,013.76	\$800.00	\$200.00	\$4,293.67
1005	1513 W TOMAH	CORONA SANTIAGO & JOSEFA V	251292006	7446.0159	0.1778	\$13,446.10	RM-2	120	1	\$3,079.95	\$1,013.76	\$800.00	\$200.00	\$4,293.67
1006	1489 W TOMAH	KLEINRAMER PAUL & JANE	251292008	2268.1588	0.0482	\$13,446.10	RM-2	120	1	\$3,079.95	\$1,013.76	\$800.00	\$200.00	\$4,293.67
1007	1525 W PUTNAM	HOSFELDT DOUGLAS R	251301002	4958.2386	0.1075	\$13,446.10	RM-2	50	1	\$1,013.76	\$800.00	\$200.00	\$200.00	\$1,813.76
1008	1525 W PUTNAM	CONNELL ORENIS	251301003	15506.2614	0.3560	\$13,446.10	RM-2	132	1	\$2,372.54	\$2,376.00	\$800.00	\$200.00	\$15,068.54
1009	1495 W PUTNAM	WELKER MARGARET L (SCSR TR OF CS & WELKER MARGARET L (SCSR TR OF CS & SPENCER CHARLES S & MARY LOU (TRS)	251301005	10137.9702	0.2209	\$13,446.10	RM-2	80	1	\$4,787.01	\$0.00	\$800.00	\$200.00	\$4,987.01
1010	1477 W PUTNAM	BEDOLLA JAVIER TORRES	251301007	9762.0558	0.2247	\$13,446.10	RM-2	50	1	\$3,129.39	\$2,376.00	\$800.00	\$200.00	\$5,546.21
1011	1465 W PUTNAM	ZAVALA JOSE LUIS	251301008	10014.4129	0.2247	\$13,446.10	RM-2	50	1	\$3,129.39	\$2,376.00	\$800.00	\$200.00	\$5,546.21
1012	1463 W PUTNAM	HAWKINS JAMES W & JUANITA	251301009	9889.5751	0.2209	\$13,446.10	RM-2	50	1	\$3,092.71	\$2,376.00	\$800.00	\$200.00	\$5,291.29
1013	1455 W PUTNAM	MARTINEZ ALEJANDRO N & NORMA E	251301010	9991.8264	0.2270	\$13,446.10	RM-2	50	1	\$3,084.28	\$2,376.00	\$800.00	\$200.00	\$5,660.28
1014	1443 W PUTNAM	CERBALLOS ARTURO CORONA	251301011	8461.6587	0.1943	\$13,446.10	RM-2	50	1	\$2,611.94	\$2,376.00	\$800.00	\$200.00	\$5,187.94
1015	177 N BEVERLY	GUERRERO IRENE	251301012	8817.9687	0.2024	\$13,446.10	RS-2	46	1	\$2,721.88	\$1,013.76	\$800.00	\$200.00	\$3,935.64
1016	165 N BEVERLY	CELLEN KEN P & LORI D	251301013	8930.4482	0.2064	\$13,446.10	RS-2	67	1	\$2,759.31	\$1,013.76	\$800.00	\$200.00	\$3,973.07
1017	137 N BEVERLY	RAMIREZ CRESCENCIANO M & RENEE FLOR	251301014	8900.3502	0.2064	\$13,446.10	RS-2	67	1	\$2,759.31	\$1,013.76	\$800.00	\$200.00	\$3,973.07
1018	137 N BEVERLY	VALINE MARIE A	251301015	8565.7804	0.2064	\$13,446.10	RS-2	67	1	\$2,759.31	\$1,013.76	\$800.00	\$200.00	\$3,973.07
1019	125 N BEVERLY	PEREZ ROBERTO & REYNA	251301016	8802.407	0.2021	\$13,446.10	RS-2	67	1	\$2,759.31	\$1,013.76	\$800.00	\$200.00	\$3,973.07
1020	107 N BEVERLY	PEREZ ROBERTO & REYNA	251301017	8793.6896	0.2021	\$13,446.10	RS-2	67	1	\$2,759.31	\$1,013.76	\$800.00	\$200.00	\$3,973.07
1021	107 N BEVERLY	PEREZ ROBERTO & REYNA	251301018	8842.3451	0.2045	\$13,446.10	RS-2	67	1	\$2,759.31	\$1,013.76	\$800.00	\$200.00	\$3,973.07
1022	1474 W TOMAH	PEREYRA ESPERANZA HOPE	251301021	12382.7662	0.2843	\$13,446.10	RS-2	47	1	\$3,822.32	\$2,759.31	\$800.00	\$200.00	\$6,999.32
1023	1456 W TOMAH	ORTIZ LEOCADIO JR	251301022	1959.2844	0.0444	\$13,446.10	RM-2	0	1	\$3,822.32	\$2,759.31	\$800.00	\$200.00	\$6,999.32
1024	1456 W TOMAH	AGUILAR JOSE MERCADERO	251301024	1959.2844	0.0444	\$13,446.10	RM-2	0	1	\$3,822.32	\$2,759.31	\$800.00	\$200.00	\$6,999.32
1025	1440 W TOMAH	WELKER MARGARET L (SCSR TR OF CS & WELKER MARGARET L (SCSR TR OF CS & HOLWORTHY JOHN C	251301028	28300.2097	0.6497	\$13,446.10	RM-2	0	1	\$8,735.71	\$1,013.76	\$800.00	\$200.00	\$9,949.47
1026	1504 W TOMAH	ALCANTARA MARIO	251301037	19001.8764	0.4444	\$13,446.10	RM-2	129	1	\$6,630.72	\$1,013.76	\$800.00	\$200.00	\$8,444.48
1027	1516 W TOMAH	NUÑEZ SOFIA	251301038	19911.9317	0.4513	\$13,446.10	RM-2	66	1	\$6,109.93	\$1,013.76	\$800.00	\$200.00	\$7,924.69
1028	1534 TOMAH	NUÑEZ SOFIA	251301039	19853.7075	0.4513	\$13,446.10	RM-2	66	1	\$6,109.93	\$1,013.76	\$800.00	\$200.00	\$7,924.69
1029	1498 W TOMAH	GUTIERREZ CARLOS	251301042	12149.6914	0.2782	\$13,446.10	RM-2	66	1	\$3,411.11	\$2,376.00	\$800.00	\$200.00	\$6,787.11
1030	1498 W TOMAH	GUTIERREZ CARLOS	251301043	17181.1233	0.3947	\$13,446.10	RM-2	66	1	\$5,006.56	\$2,376.00	\$800.00	\$200.00	\$7,882.56
1031	1417 W PUTNAM	THOMPSON TRACY L	251301035	9812.4441	0.2276	\$13,446.10	RM-2	116	1	\$3,659.83	\$2,376.00	\$800.00	\$200.00	\$5,635.83
1032	1417 W PUTNAM	KONDAUR CAPITAL CORPORATION	251302001	8471.5624	0.1945	\$13,446.10	RM-2	82	1	\$2,615.00	\$2,376.00	\$800.00	\$200.00	\$5,191.00
1033	178 N BEVERLY	DUFF MARIA D	251302002	8005.4198	0.2045	\$13,446.10	RS-2	115	1	\$2,718.06	\$1,013.76	\$800.00	\$200.00	\$3,931.82
1034	166 N BEVERLY	ZEPEDA JESUS	251302003	8959.3185	0.2057	\$13,446.10	RS-2	67	1	\$2,658.69	\$1,013.76	\$800.00	\$200.00	\$3,973.15
1035	158 N BEVERLY	GONZALEZ RAMON A	251302004	8939.3185	0.2057	\$13,446.10	RS-2	67	1	\$2,658.69	\$1,013.76	\$800.00	\$200.00	\$3,973.15
1036	148 N BEVERLY	LINARES TERESA	251302005	8667.3222	0.2036	\$13,446.10	RS-2	67	1	\$2,437.16	\$1,013.76	\$800.00	\$200.00	\$3,950.92
1037	134 N BEVERLY	BUTTERBAUGH JENNIFER	251302006	8665.3569	0.1987	\$13,446.10	RS-2	67	1	\$2,671.74	\$1,013.76	\$800.00	\$200.00	\$3,885.50
1038	126 N BEVERLY	FERNANDEZ J REFUGIO & LILIA	251302007	8665.1534	0.1989	\$13,446.10	RS-2	67	1	\$2,674.76	\$1,013.76	\$800.00	\$200.00	\$3,889.52

(1)	(2)	(3)	(4)	(5)	(6)	(7)	(8)	(9)	(10)	(11)	(12)	(13)	(14)	(15)
Property No.	Property Address	Owner	Assessor Parcel No.	Lot Area (SF)	Lot Area (AC)	Acres/Fee/Acre	Zoning	Front Footage	Units per Lot	Acres Fee	Sewer Lateral Cost	Plumbing/Footing/Remediation	Construction Management Cost	Total Connection Fees
1049	114 N BEVERLY	RAMOS PEDRO JR	2513022008	8659.8505	0.1988	\$13,446.10	RS-2	67	1	\$2,673.12	\$1,013.76	\$80.00	\$200.00	\$3,886.88
1050	1410 TOMAH	BANK OF NEW YORK MELLON THE(TR)	2513022009	6761.3121	0.2011	\$13,446.10	RS-2	67	1	\$2,704.46	\$1,013.76	\$80.00	\$200.00	\$2,904.46
1052	266 N THURMAN	STURGEON TRACY W	251311002	12047.6245	0.1764	\$13,446.10	RS-2	61	1	\$3,718.83	\$1,013.76	\$80.00	\$200.00	\$4,922.59
1055	1569 W THURMAN	RODRIGUEZ ENRIQUE & DIGNA R	251311005	7595.0490	0.2178	\$13,446.10	RS-2	72	1	\$2,344.44	\$1,013.76	\$80.00	\$200.00	\$4,920.44
1056	283 N LOTAS	VASQUEZ NAPOLION J & FLORA	251311007	11687.2818	0.2678	\$13,446.10	RS-2	85	1	\$3,663.19	\$1,013.76	\$80.00	\$200.00	\$4,916.95
1057	285 LOTAS	DAVIES GLEN H & MARY L (C)	251311008	11683.9478	0.2678	\$13,446.10	RS-2	41	1	\$3,663.58	\$1,013.76	\$80.00	\$200.00	\$4,916.34
1058	277 N LOTAS	GILLESPIE SHELBY WAYNE	251311009	11768.1071	0.2702	\$13,446.10	RS-2	61	1	\$3,705.49	\$1,013.76	\$80.00	\$200.00	\$4,920.25
1059	267 N LOTAS	IBARRA ROBERTO M	251311010	12007.5400	0.2757	\$13,446.10	RS-2	61	1	\$3,728.54	\$1,013.76	\$80.00	\$200.00	\$4,930.30
1060	255 N LOTAS	TAYLOR BRIAN	251311011	23735.0594	0.6469	\$13,446.10	RS-2	122	1	\$3,699.62	\$1,013.76	\$80.00	\$200.00	\$4,913.38
1061	237 N LOTAS	BLANKENSHIP EDSEL R & SYLVIA M	251311012	11985.2795	0.2751	\$13,446.10	RS-2	72	1	\$3,622.21	\$1,013.76	\$80.00	\$200.00	\$4,826.97
1062	229 N LOTAS	GARZA NORMA	251311013	11734.5023	0.2684	\$13,446.10	RS-2	61	1	\$2,850.40	\$1,013.76	\$80.00	\$200.00	\$3,864.16
1063	221 N LOTAS	JOHNSON CHARLES E & PEGGY A	251311014	7290.3909	0.1674	\$13,446.10	RS-2	61	1	\$2,850.40	\$1,013.76	\$80.00	\$200.00	\$3,864.16
1064	209 N LOTAS	TURIBIO HENRY J & DOLORES P	251311015	9395.3241	0.1918	\$13,446.10	RS-2	41	1	\$2,901.39	\$1,013.76	\$80.00	\$200.00	\$3,925.04
1065	1554 W PUTNAM	PEREZ EMMA HARO DE	251311016	11712.2047	0.2555	\$13,446.10	RS-2	75	1	\$2,743.02	\$1,013.76	\$80.00	\$200.00	\$3,756.78
1066	212 N NEWCOMB	MUHAMMED SALIMA & SHAMMUS (TRS)	251311017	11859.0389	0.2723	\$13,446.10	RS-2	72	1	\$2,743.02	\$1,013.76	\$80.00	\$200.00	\$3,756.78
1067	232 N NEWCOMB	MARTINEZ MARTHA O	251311018	11916.0389	0.2810	\$13,446.10	RS-2	72	1	\$2,743.02	\$1,013.76	\$80.00	\$200.00	\$3,756.78
1068	250 N NEWCOMB	SANTA MARIA ANTONIO JR	251312001	1697.9346	0.0391	\$13,446.10	RS-2	61	1	\$3,699.62	\$1,013.76	\$80.00	\$200.00	\$4,913.38
1069	286 N LOTAS	DAVIS BRIE	251312002	11430.9768	0.2659	\$13,446.10	RS-2	61	1	\$3,699.62	\$1,013.76	\$80.00	\$200.00	\$4,913.38
1070	288 N LOTAS	SWINDLE CHARLES JOSEPH & JUNE	251312003	11430.9768	0.2659	\$13,446.10	RS-2	61	1	\$3,699.62	\$1,013.76	\$80.00	\$200.00	\$4,913.38
1071	286 N LOTAS	DAVIS GLEN H & MARY L	251312004	11430.9768	0.2659	\$13,446.10	RS-2	61	1	\$3,699.62	\$1,013.76	\$80.00	\$200.00	\$4,913.38
1072	284 N LOTAS	HARRIS LARRY & TRUB HARRIS L	251312005	10810.7059	0.2482	\$13,446.10	RS-2	41	1	\$3,337.07	\$1,013.76	\$80.00	\$200.00	\$4,551.83
1073	294 N LOTAS	BIRGWAY JEROME & TRUB HARRIS L	251312006	10810.7059	0.2482	\$13,446.10	RS-2	41	1	\$3,337.07	\$1,013.76	\$80.00	\$200.00	\$4,551.83
1074	293 N LINDALE	WELDON SUZANNE	251312007	11589.8229	0.2432	\$13,446.10	RS-2	59	1	\$3,270.23	\$1,013.76	\$80.00	\$200.00	\$4,484.99
1075	292 N LINDALE	WELDON SUZANNE	251312008	11589.8229	0.2432	\$13,446.10	RS-2	59	1	\$3,270.23	\$1,013.76	\$80.00	\$200.00	\$4,484.99
1076	290 N LINDALE	WELDON SUZANNE	251312009	11589.8229	0.2432	\$13,446.10	RS-2	59	1	\$3,270.23	\$1,013.76	\$80.00	\$200.00	\$4,484.99
1077	290 N LINDALE	WELDON SUZANNE	251312010	11589.8229	0.2432	\$13,446.10	RS-2	59	1	\$3,270.23	\$1,013.76	\$80.00	\$200.00	\$4,484.99
1078	245 N LINDALE	WELDON SUZANNE	251312011	11589.8229	0.2432	\$13,446.10	RS-2	59	1	\$3,270.23	\$1,013.76	\$80.00	\$200.00	\$4,484.99
1079	233 N LINDALE	WELDON SUZANNE	251312012	11589.8229	0.2432	\$13,446.10	RS-2	59	1	\$3,270.23	\$1,013.76	\$80.00	\$200.00	\$4,484.99
1080	230 N LOTAS	WELDON SUZANNE	251312013	11589.8229	0.2432	\$13,446.10	RS-2	59	1	\$3,270.23	\$1,013.76	\$80.00	\$200.00	\$4,484.99
1081	238 N LOTAS	WELDON SUZANNE	251312014	11589.8229	0.2432	\$13,446.10	RS-2	59	1	\$3,270.23	\$1,013.76	\$80.00	\$200.00	\$4,484.99
1082	246 N LOTAS	WELDON SUZANNE	251312015	11589.8229	0.2432	\$13,446.10	RS-2	59	1	\$3,270.23	\$1,013.76	\$80.00	\$200.00	\$4,484.99
1083	222 N LOTAS	WELDON SUZANNE	251312016	11589.8229	0.2432	\$13,446.10	RS-2	59	1	\$3,270.23	\$1,013.76	\$80.00	\$200.00	\$4,484.99
1084	1622 W PUTNAM	WELDON SUZANNE	251312017	11710.0063	0.2661	\$13,446.10	RS-2	61	1	\$3,617.42	\$1,013.76	\$80.00	\$200.00	\$4,791.18
1085	1498 W PUTNAM	LOPEZ ESPARZA CESARIO	251312022	8435.9590	0.1937	\$13,446.10	RS-2	169	1	\$2,411.47	\$1,013.76	\$80.00	\$200.00	\$3,615.23
1086	1498 W PUTNAM	LOPEZ ESPARZA CESARIO	251312022	8435.9590	0.1937	\$13,446.10	RS-2	169	1	\$2,411.47	\$1,013.76	\$80.00	\$200.00	\$3,615.23
1087	270 N LINDALE	LUNA YSIDORO R & GUADALUPE C	251313002	10237.9562	0.2453	\$13,446.10	RS-2	59	1	\$2,603.87	\$1,013.76	\$80.00	\$200.00	\$3,615.23
1088	260 N LINDALE	ANASTASOFF STEVEN W & MARY J	251313003	10251.2840	0.2453	\$13,446.10	RS-2	59	1	\$2,603.87	\$1,013.76	\$80.00	\$200.00	\$3,615.23
1089	1455 W THURMAN	THOMAS BERNIE D & BETTY L (TRS)	251313004	10251.2840	0.2453	\$13,446.10	RS-2	59	1	\$2,603.87	\$1,013.76	\$80.00	\$200.00	\$3,615.23
1090	273 N BEVERLY	NINOLA ARCHADIO & LYDIA	251313005	10251.2840	0.2453	\$13,446.10	RS-2	59	1	\$2,603.87	\$1,013.76	\$80.00	\$200.00	\$3,615.23
1091	263 N BEVERLY	NIELSEN LAURA M & NEST R	251313006	8414.4529	0.2023	\$13,446.10	RS-2	115	1	\$2,115.43	\$1,013.76	\$80.00	\$200.00	\$3,134.54
1092	261 N BEVERLY	BOURBAULT ALAN & PORTIA MICO-T	251313007	8414.4529	0.2023	\$13,446.10	RS-2	67	1	\$2,115.43	\$1,013.76	\$80.00	\$200.00	\$3,134.54
1093	239 N BEVERLY	MARTINEZ ALEJANDRO & NORMA	251313008	8698.4284	0.2058	\$13,446.10	RS-2	67	1	\$2,115.43	\$1,013.76	\$80.00	\$200.00	\$3,134.54
1094	239 N BEVERLY	MARTINEZ ALEJANDRO & NORMA	251313008	8698.4284	0.2058	\$13,446.10	RS-2	67	1	\$2,115.43	\$1,013.76	\$80.00	\$200.00	\$3,134.54
1095	1442 W PUTNAM	ESCALERA ARTHUR & CAROL	251313010	9021.3143	0.2071	\$13,446.10	RS-2	67	1	\$2,115.43	\$1,013.76	\$80.00	\$200.00	\$3,134.54
1096	221 N BEVERLY	ESCALERA ARTHUR & CAROL	251313011	8915.0325	0.2047	\$13,446.10	RS-2	67	1	\$2,115.43	\$1,013.76	\$80.00	\$200.00	\$3,134.54
1097	1478 W PUTNAM	LOPEZ JOE & INES	251313012	8943.8363	0.2053	\$13,446.10	RS-2	67	1	\$2,115.43	\$1,013.76	\$80.00	\$200.00	\$3,134.54
1098	232 N LINDALE	LOPEZ JOE & INES	251313013	8943.8363	0.2053	\$13,446.10	RS-2	67	1	\$2,115.43	\$1,013.76	\$80.00	\$200.00	\$3,134.54
1099	246 LINDALE	TATE LAWANAL	251313014	15043.3565	0.3453	\$13,446.10	RS-2	115	1	\$3,160.25	\$1,013.76	\$80.00	\$200.00	\$4,374.01
1100	254 LINDALE	CLARK EDWARD V	251313015	10237.9562	0.2453	\$13,446.10	RS-2	101	1	\$3,092.01	\$1,013.76	\$80.00	\$200.00	\$4,272.77
1101	1464 W PUTNAM	MAGANA GERARDO & ROSALINA	251313017	9919.7032	0.2319	\$13,446.10	RS-2	75	1	\$3,118.51	\$1,013.76	\$80.00	\$200.00	\$4,332.27
1103	1452 W PUTNAM	CANUALES EFREN	251313025	10292.6884	0.2363	\$13,446.10	RS-2	75	1	\$3,177.15	\$1,013.76	\$80.00	\$200.00	\$4,354.15
1104	289 N BEVERLY	HASTINGS WILLIAM A	251313029	8877.8526	0.2038	\$13,446.10	RS-2	29	1	\$2,740.45	\$1,013.76	\$80.00	\$200.00	\$3,754.21
1105	1407 W THURMAN	PETERSON LOIS	251313030	15801.7406	0.3628	\$13,446.10	RS-2	60	1	\$4,677.68	\$1,013.76	\$80.00	\$200.00	\$5,681.44
1106	284 N BEVERLY	LOPEZ JOE & INES	251314001	8759.0941	0.2011	\$13,446.10	RS-2	114	1	\$2,703.45	\$1,013.76	\$80.00	\$200.00	\$3,717.21
1107	274 N BEVERLY	LOPEZ JOE & INES	251314002	8668.1072	0.2036	\$13,446.10	RS-2	115	1	\$2,737.41	\$1,013.76	\$80.00	\$200.00	\$3,751.17
1108	264 N BEVERLY	BEAUCHAMP EZERY & KERI	251314003	9098.4520	0.2089	\$13,446.10	RS-2	67	1	\$2,808.51	\$1,013.76	\$80.00	\$200.00	\$3,822.27
1109	252 N BEVERLY	CARRILLO RICARDO & BEATRICE G	251314004	8794.9506	0.2019	\$13,446.10	RS-2	67	1	\$2,714.83	\$1,013.76	\$80.00	\$200.00	\$3,728.59
1110	240 N BEVERLY	PEREZ GARY C & BEBECCA	251314005	8904.1306	0.2044	\$13,446.10	RS-2	67	1	\$2,748.53	\$1,013.76	\$80.00	\$200.00	\$3,762.29
1111	230 N BEVERLY	COCHRAN KARIN K (L EST)	251314006	8952.3043	0.2055	\$13,446.10	RS-2	67	1	\$2,765.40	\$1,013.76	\$80.00	\$200.00	\$3,771.16
1112	222 N BEVERLY	EDWARDS NORRIS G II & MARY C	251314007	9031.3051	0.2078	\$13,446.10	RS-2	67	1	\$2,793.96	\$1,013.76	\$80.00	\$200.00	\$3,807.72
1116	385 N LOTAS	MEIER JUSTIN & KODANN UPTRAIN	251314008	8946.7481	0.2054	\$13,446.10	RS-2	67	1	\$2,793.96	\$1,013.76	\$80.00	\$200.00	\$3,807.72
1117	373 N LOTAS	MALDONADO MORENO	251314009	11878.3556	0.2727	\$13,446.10	RS-2	81	1	\$3,663.19	\$1,013.76	\$80.00	\$200.00	\$4,676.95
1118	365 N LOTAS	FERRARI MARGARETTA BEBE												

(1) Property No.	(2) Property Address	(3) Owner	(4) Assessor Parcel No.	(5) Lot Area (SF)	(6) Lot Area (AC)	(7) Acreage Fee/Acre	(8) Zoning	(9) Lot Front Footage	(10) Units per Lot	(11) Average Fee	(12) Sewer Lateral Cost	(13) Plumbing Permit	(14) Construction Management Cost	(15) Total Connection Fees
1128	1557 W MORTON	WILSON REX & KATHLEEN A	251321023	5582.7489	0.1282	\$13,446.10	RS-2	92	1	\$1,723.26	\$1,013.76	\$800.00	\$200.00	\$2,937.04
1130	393 N LOTAS	ZUNIGA MINERVA	251321025	6370.2149	0.1462	\$13,446.10	RS-2	50	1	\$1,956.36	\$1,013.76	\$800.00	\$200.00	\$3,180.12
1132	350 N LOTAS	WOOD RICHARD C & CINDY	251322002	22464.3080	0.5157	\$13,446.10	RS-2	132	1	\$6,934.29	\$1,013.76	\$800.00	\$200.00	\$8,148.04
1133	366 N LOTAS	BAKTER ARTHUR R & MILDRED M (TRS)	251322002	11780.9689	0.2690	\$13,446.10	RS-2	61	1	\$3,482.21	\$1,013.76	\$800.00	\$200.00	\$4,695.97
1134	376 N LOTAS	GIFFORD LENORA	251322003	11716.4945	0.2690	\$13,446.10	RS-2	61	1	\$3,616.65	\$1,013.76	\$800.00	\$200.00	\$4,930.41
1135	386 N LOTAS	MAGANA SIDRO	251322004	11305.5652	0.2690	\$13,446.10	RS-2	48	1	\$2,889.81	\$1,013.76	\$800.00	\$200.00	\$4,093.57
1136	391 N LINDALE	PEREZ RICARDO & IRENE	251322008	9244.3175	0.2172	\$13,446.10	RS-2	48	1	\$2,953.54	\$1,013.76	\$800.00	\$200.00	\$4,067.30
1137	381 N LINDALE	GUINNI KATHY	251322008	8950.9206	0.2078	\$13,446.10	RS-2	68	1	\$2,765.90	\$1,013.76	\$800.00	\$200.00	\$3,969.66
1138	369 N LINDALE	TENA ARMANDO	251322009	8950.9206	0.2078	\$13,446.10	RS-2	68	1	\$2,765.90	\$1,013.76	\$800.00	\$200.00	\$3,969.66
1139	361 N LINDALE	SMITH CHERYL	251322010	8918.8014	0.2061	\$13,446.10	RS-2	68	1	\$2,711.06	\$1,013.76	\$800.00	\$200.00	\$3,913.82
1140	349 N LINDALE	GOMEZ AIDA HERNANDEZ (LILV TR)	251322011	9109.8014	0.2091	\$13,446.10	RS-2	68	1	\$2,811.18	\$1,013.76	\$800.00	\$200.00	\$4,014.94
1141	337 N LINDALE	ESPINOSA DOMINGO	251322012	9017.9581	0.2084	\$13,446.10	RS-2	68	1	\$2,800.60	\$1,013.76	\$800.00	\$200.00	\$4,014.94
1142	325 N LINDALE	CAULK STEVEND & JOEL	251322013	9163.1586	0.2108	\$13,446.10	RS-2	68	1	\$2,867.38	\$1,013.76	\$800.00	\$200.00	\$4,071.14
1143	1482 W THURMAN	PEZ MARI K & BOBBIE LESTER	251322014	8740.0934	0.2084	\$13,446.10	RS-2	68	1	\$2,800.60	\$1,013.76	\$800.00	\$200.00	\$4,014.94
1144	327 N LOTAS	PEREZ MARI K & BOBBIE LESTER	251322015	11039.0934	0.2635	\$13,446.10	RS-2	68	1	\$2,800.60	\$1,013.76	\$800.00	\$200.00	\$4,014.94
1145	326 N LOTAS	GARCIA M LARRY (EVOC TR)	251322016	11536.4239	0.2648	\$13,446.10	RS-2	115	1	\$3,543.37	\$1,013.76	\$800.00	\$200.00	\$4,743.13
1146	316 N LOTAS	AGUILAR MOSES E L	251322017	11706.1746	0.2687	\$13,446.10	RS-2	61	1	\$3,581.06	\$1,013.76	\$800.00	\$200.00	\$4,784.82
1147	1507 W MORTON	BELTRAN RUDY P	251322020	11733.8333	0.2684	\$13,446.10	RS-2	61	1	\$3,622.00	\$1,013.76	\$800.00	\$200.00	\$4,823.76
1148	392 N LOTAS	QUINTANA JOE & JULIE	251322021	5108.6558	0.1173	\$13,446.10	RS-2	42	1	\$1,677.00	\$1,013.76	\$800.00	\$200.00	\$2,790.76
1149	350 N LINDALE	ALTAMIRANO SAUL	251322023	6956.5339	0.1597	\$13,446.10	RS-2	61	1	\$2,147.34	\$1,013.76	\$800.00	\$200.00	\$3,361.10
1150	362 N LINDALE	RODRIGUEZ ROSEMARY	251323002	8902.8825	0.2044	\$13,446.10	RS-2	52	1	\$2,807.95	\$1,013.76	\$800.00	\$200.00	\$4,021.71
1151	370 N LINDALE	RANGEL JULIAN JR & RUTH (TRS)	251323003	9004.8225	0.2076	\$13,446.10	RS-2	68	1	\$2,778.60	\$1,013.76	\$800.00	\$200.00	\$3,993.36
1152	370 N LINDALE	BANKS WICKIE	251323004	9041.6479	0.2076	\$13,446.10	RS-2	68	1	\$2,790.98	\$1,013.76	\$800.00	\$200.00	\$4,004.74
1153	380 N LINDALE	MC QUEEN MADENA L	251323005	9291.6065	0.2123	\$13,446.10	RS-2	68	1	\$2,868.13	\$1,013.76	\$800.00	\$200.00	\$4,081.89
1154	392 N LINDALE	DICKEY MARY LOU G & JEFFERSON D	251323006	9248.3577	0.2123	\$13,446.10	RS-2	68	1	\$2,854.79	\$1,013.76	\$800.00	\$200.00	\$4,068.55
1155	387 BEVERLY	INGRAM CRYSTAL D	251323007	9013.9293	0.2069	\$13,446.10	RS-2	48	1	\$2,782.39	\$1,013.76	\$800.00	\$200.00	\$3,996.15
1156	379 N BEVERLY	LADY LORI R	251323008	8882.2657	0.2039	\$13,446.10	RS-2	68	1	\$2,741.78	\$1,013.76	\$800.00	\$200.00	\$3,954.54
1157	369 N BEVERLY	ANDERSON JOSEPH F & DELORES A	251323009	8781.7426	0.2016	\$13,446.10	RS-2	68	1	\$2,710.75	\$1,013.76	\$800.00	\$200.00	\$3,924.51
1158	361 N BEVERLY	ESPINOSA MIGUEL A	251323010	8930.8730	0.2050	\$13,446.10	RS-2	68	1	\$2,756.78	\$1,013.76	\$800.00	\$200.00	\$3,970.54
1159	343 N BEVERLY	ROBLES APOLINAR	251323011	9024.0163	0.2072	\$13,446.10	RS-2	68	1	\$2,795.53	\$1,013.76	\$800.00	\$200.00	\$4,009.29
1160	337 N BEVERLY	ARCURE FRANKLIN C & PATRICIA K (TRS)	251323012	8832.1948	0.2028	\$13,446.10	RS-2	68	1	\$2,726.41	\$1,013.76	\$800.00	\$200.00	\$3,949.17
1161	323 N BEVERLY	BOONE DANNY W & MARIAL	251323013	9047.2232	0.2077	\$13,446.10	RS-2	68	1	\$2,792.70	\$1,013.76	\$800.00	\$200.00	\$4,001.46
1162	315 N BEVERLY	CORTEZ JOSE JR	251323014	9304.2804	0.2136	\$13,446.10	RS-2	68	1	\$2,834.28	\$1,013.76	\$800.00	\$200.00	\$4,048.04
1163	1454 W THURMAN	DILLON JOHNNY D & PATRICIA A	251323015	8908.8959	0.2182	\$13,446.10	RS-2	68	1	\$2,840.64	\$1,013.76	\$800.00	\$200.00	\$4,051.40
1164	328 N LINDALE	BARRIOS ALBERTO	251323016	9088.8992	0.2088	\$13,446.10	RS-2	50	1	\$2,805.38	\$1,013.76	\$800.00	\$200.00	\$4,009.14
1165	328 N LINDALE	OSUNA ROSA M & JOHANN GA	251323017	9145.0988	0.2089	\$13,446.10	RS-2	68	1	\$2,822.91	\$1,013.76	\$800.00	\$200.00	\$4,036.67
1166	336 N LINDALE	MECHELY BETTY P	251324001	9268.6653	0.2132	\$13,446.10	RS-2	68	1	\$2,866.58	\$1,013.76	\$800.00	\$200.00	\$4,080.34
1167	309 N BEVERLY	AGUIAR MARTINEZ MANA M	251324002	8981.7695	0.2041	\$13,446.10	RS-2	48	1	\$2,444.40	\$1,013.76	\$800.00	\$200.00	\$3,658.16
1168	370 N BEVERLY	KNOTT RICHARD A & LYNDIA S	251324003	8782.7487	0.2016	\$13,446.10	RS-2	68	1	\$2,711.06	\$1,013.76	\$800.00	\$200.00	\$3,954.82
1169	356 N BEVERLY	BAGGETT CLARENCE & CAROL (TRS)	251324004	9009.9459	0.2068	\$13,446.10	RS-2	68	1	\$2,781.18	\$1,013.76	\$800.00	\$200.00	\$3,994.94
1170	344 N BEVERLY	GENTLER JOE & KAREN	251324005	9072.8181	0.2083	\$13,446.10	RS-2	68	1	\$2,800.60	\$1,013.76	\$800.00	\$200.00	\$4,014.36
1171	338 N BEVERLY	BECK ELIZABETH A	251324006	8931.5287	0.2050	\$13,446.10	RS-2	68	1	\$2,756.98	\$1,013.76	\$800.00	\$200.00	\$3,970.74
1172	324 N BEVERLY	PATTERSON KATHERINE M	251324007	9183.3280	0.2110	\$13,446.10	RS-2	68	1	\$2,837.80	\$1,013.76	\$800.00	\$200.00	\$4,051.56
1173	316 N BEVERLY	GALLANG WILFREDO	251324008	9462.7269	0.2172	\$13,446.10	RS-2	68	1	\$3,020.95	\$1,013.76	\$800.00	\$200.00	\$4,134.71
1174	1408 W THURMAN		4933831.4922	113.2608		\$13,446.10		68	1	\$1,522.813.28	\$492.022.08	\$355.920.00	\$89.000.00	\$2,104.335.38

Annexation No. 458 Total Parcel Count: 481
 Annexation No. 458 Participating Parcel Count: 449
 Annexation No. 458 Lateral Count: 418

General Construction Cost	Bid Amount	\$1,384,466.24
Lateral Cost		\$492,022.08
Equitable Acreage Fee		\$1,831,759.04
		\$1,522,912.86 / 13.2608 acres = \$113,446.10 per acre
		\$113,446.10 x 1.10 = \$124,790.71
		\$124,790.71 x 1.10 = \$137,269.78
		\$137,269.78 x 1.10 = \$151,000.00
		\$151,000.00 x 1.10 = \$166,100.00
		\$166,100.00 x 1.10 = \$182,710.00
		\$182,710.00 x 1.10 = \$201,000.00
		\$201,000.00 x 1.10 = \$221,100.00
		\$221,100.00 x 1.10 = \$243,210.00
		\$243,210.00 x 1.10 = \$267,531.00
		\$267,531.00 x 1.10 = \$294,284.10
		\$294,284.10 x 1.10 = \$323,712.51
		\$323,712.51 x 1.10 = \$356,083.76
		\$356,083.76 x 1.10 = \$391,692.14
		\$391,692.14 x 1.10 = \$429,861.35
		\$429,861.35 x 1.10 = \$470,847.49
		\$470,847.49 x 1.10 = \$515,932.23
		\$515,932.23 x 1.10 = \$567,525.46
		\$567,525.46 x 1.10 = \$626,278.01
		\$626,278.01 x 1.10 = \$692,905.81
		\$692,905.81 x 1.10 = \$762,196.39
		\$762,196.39 x 1.10 = \$838,416.03
		\$838,416.03 x 1.10 = \$922,257.63
		\$922,257.63 x 1.10 = \$1,014,483.40
		\$1,014,483.40 x 1.10 = \$1,115,931.74
		\$1,115,931.74 x 1.10 = \$1,227,524.91
		\$1,227,524.91 x 1.10 = \$1,350,277.40
		\$1,350,277.40 x 1.10 = \$1,485,305.14
		\$1,485,305.14 x 1.10 = \$1,633,835.66
		\$1,633,835.66 x 1.10 = \$1,797,219.23
		\$1,797,219.23 x 1.10 = \$1,976,941.15
		\$1,976,941.15 x 1.10 = \$2,174,635.27
		\$2,174,635.27 x 1.10 = \$2,392,100.00
		\$2,392,100.00 x 1.10 = \$2,631,310.00
		\$2,631,310.00 x 1.10 = \$2,894,441.00
		\$2,894,441.00 x 1.10 = \$3,183,885.10
		\$3,183,885.10 x 1.10 = \$3,502,273.61
		\$3,502,273.61 x 1.10 = \$3,852,501.00
		\$3,852,501.00 x 1.10 = \$4,237,751.10
		\$4,237,751.10 x 1.10 = \$4,661,526.21
		\$4,661,526.21 x 1.10 = \$5,127,678.83
		\$5,127,678.83 x 1.10 = \$5,640,446.71
		\$5,640,446.71 x 1.10 = \$6,204,491.38
		\$6,204,491.38 x 1.10 = \$6,824,940.52
		\$6,824,940.52 x 1.10 = \$7,507,434.57
		\$7,507,434.57 x 1.10 = \$8,258,178.03
		\$8,258,178.03 x 1.10 = \$9,083,595.83
		\$9,083,595.83 x 1.10 = \$9,991,955.41
		\$9,991,955.41 x 1.10 = \$11,001,150.95
		\$11,001,150.95 x 1.10 = \$12,101,266.05
		\$12,101,266.05 x 1.10 = \$13,311,392.66
		\$13,311,392.66 x 1.10 = \$14,642,531.93
		\$14,642,531.93 x 1.10 = \$16,106,785.12
		\$16,106,785.12 x 1.10 = \$17,717,463.63
		\$17,717,463.63 x 1.10 = \$19,489,210.00
		\$19,489,210.00 x 1.10 = \$21,438,131.00
		\$21,438,131.00 x 1.10 = \$23,581,944.10

RESOLUTION NO.: _____ - 2013

A RESOLUTION OF THE CITY COUNCIL OF THE
CITY OF PORTERVILLE ACCEPTING
THE ENGINEER'S REPORT FOR
ISLAND ANNEXATION AREA 458 SEWER PROJECT

WHEREAS, Island Annexation Area 458, was annexed into the City in November 2006; and

WHEREAS, the parcels in this area utilize individual septic tanks that are failing; and

WHEREAS, an Engineer's Report has been prepared by direction of the City Council of the City of Porterville; and

WHEREAS, the report states that the new sewer system will have a positive effect upon all parcels within the proposed boundary, and provide a reliable, consistent and safe method of sewer disposal; and

WHEREAS, the report states construction costs will initially be provided by a loan from re-financed Certificate of Participation Bond Sewer funds, and establishes repayment of the loan by property owners through a Sewer Utility District; and

WHEREAS, legal descriptions of properties and the proposed assessment Boundary Map is referenced in the report;

NOW THEREFORE BE IT RESOLVED, that the City Council of the City of Porterville accepts the Engineer's Report for the Island Annexation Area 458 sewer project.

PASSED, APPROVED AND ADOPTED this 5th day of February, 2013.

Virginia R. Gurrola, Mayor

ATTEST:
John D. Lollis, City Clerk

By: _____
Patrice Hildreth, Chief Deputy City Clerk